

REVISION HISTORY				
REV	ECN	DATE	BY	DESCRIPTION
1	1204	7/15/2005	TLB	ADDED ITEM #5 - SPACER
2	3247	12/22/2015	EMT	REPLACED 1903-593 WITH 1903-808

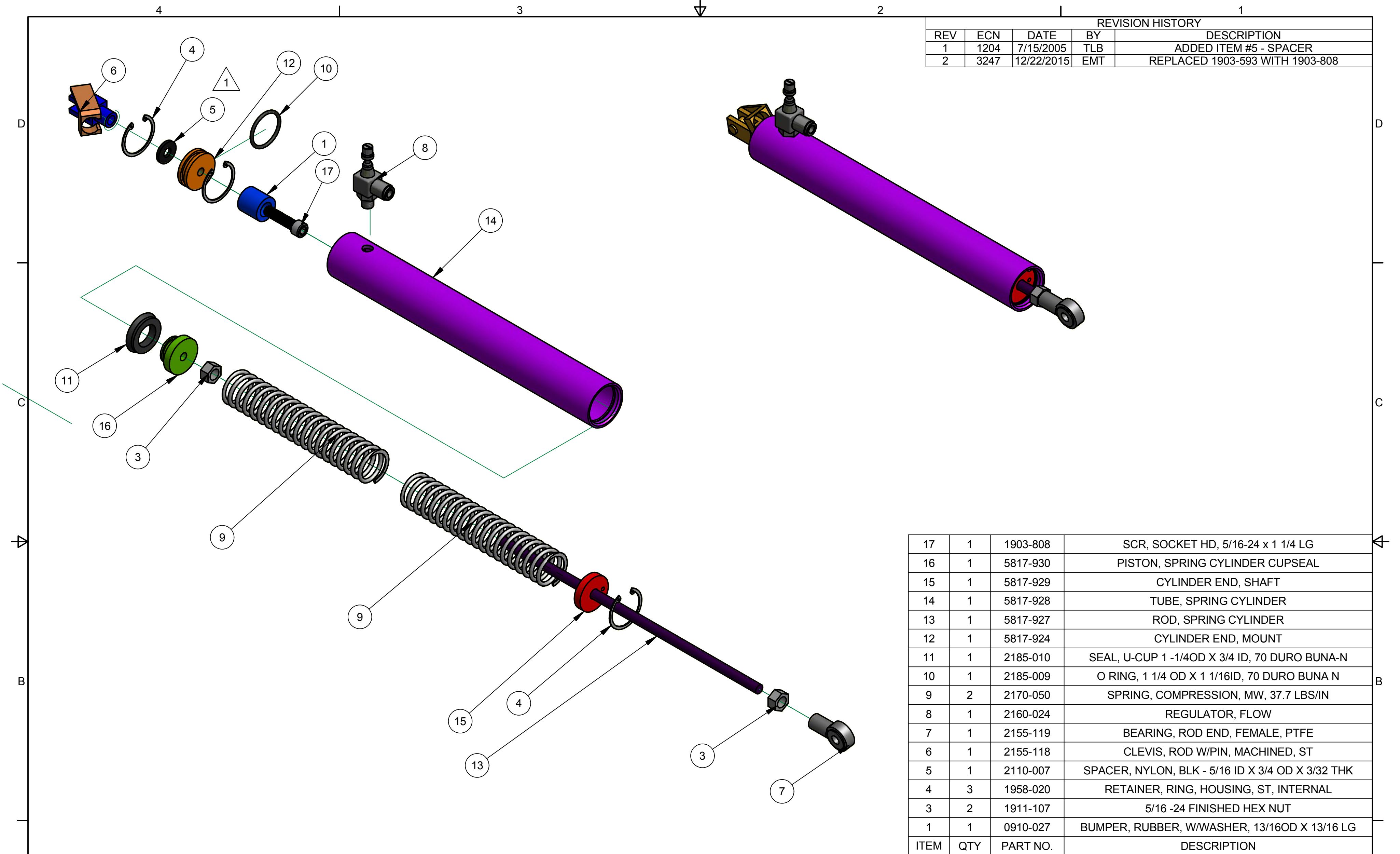

ITEM	QTY	PART NO.	DESCRIPTION
17	1	1903-808	SCR, SOCKET HD, 5/16-24 x 1 1/4 LG
16	1	5817-930	PISTON, SPRING CYLINDER CUPSEAL
15	1	5817-929	CYLINDER END, SHAFT
14	1	5817-928	TUBE, SPRING CYLINDER
13	1	5817-927	ROD, SPRING CYLINDER
12	1	5817-924	CYLINDER END, MOUNT
11	1	2185-010	SEAL, U-CUP 1 -1/4OD X 3/4 ID, 70 DURO BUNA-N
10	1	2185-009	O RING, 1 1/4 OD X 1 1/16ID, 70 DURO BUNA N
9	2	2170-050	SPRING, COMPRESSION, MW, 37.7 LBS/IN
8	1	2160-024	REGULATOR, FLOW
7	1	2155-119	BEARING, ROD END, FEMALE, PTFE
6	1	2155-118	CLEVIS, ROD W/PIN, MACHINED, ST
5	1	2110-007	SPACER, NYLON, BLK - 5/16 ID X 3/4 OD X 3/32 THK
4	3	1958-020	RETAINER, RING, HOUSING, ST, INTERNAL
3	2	1911-107	5/16 -24 FINISHED HEX NUT
1	1	0910-027	BUMPER, RUBBER, W/WASHER, 13/16OD X 13/16 LG

Material List

ALL DIMENSIONS IN INCHES EXCEPT WHERE NOTED  STANDARD TOLERANCES EXCEPT WHERE NOTED (ALL PLUS/MINUS)  2 PLC. DECIMAL: .010 3 PLC. DECIMAL: .005 FRACTION: 1/32 ANGLE: 1'	DWG BY: <b>RDS</b> DATE: <b>4/19/2005</b>		<b>HEAT SEAL/AMPAK</b> CLEVELAND, OHIO 44125	
	CHK'D BY: DATE:			
	USED ON: <b>HDS-115/215</b>		DESCRIPTION: <b>SPRING CYLINDER ASSEMBLY</b>	
	SHEET SIZE: <b>C</b>	SHEET: <b>1</b> OF: <b>1</b>	DRAWING NO. <b>5818-017</b>	REVISION: <b>2</b>
PART FILE NAME: C:\Vault Working Folder\Heat Seal Vault\Products\Industrial\Combo Systems\HDS-115\5818-017.iam				