

| REVISION HISTORY | | | | |
|------------------|-------|------------|-----|--|
| REV | ECN # | DATE | BY | DESCRIPTION |
| 1 | - | 10/21/92 | - | 14-1/2 WAS 14-5/8, 15-3/4 WAS 15-7/8 |
| 2 | 1352 | 11/16/2005 | DMS | ROLLER CONVERTED TO ASSY, DIMS CHANGED TO REF, REDRAWN IN INVENTOR |
| 3 | 2951 | 11/28/2012 | JPR | UPDATED TO SHOW CHAMFERS ADDED TO 6010-318 |

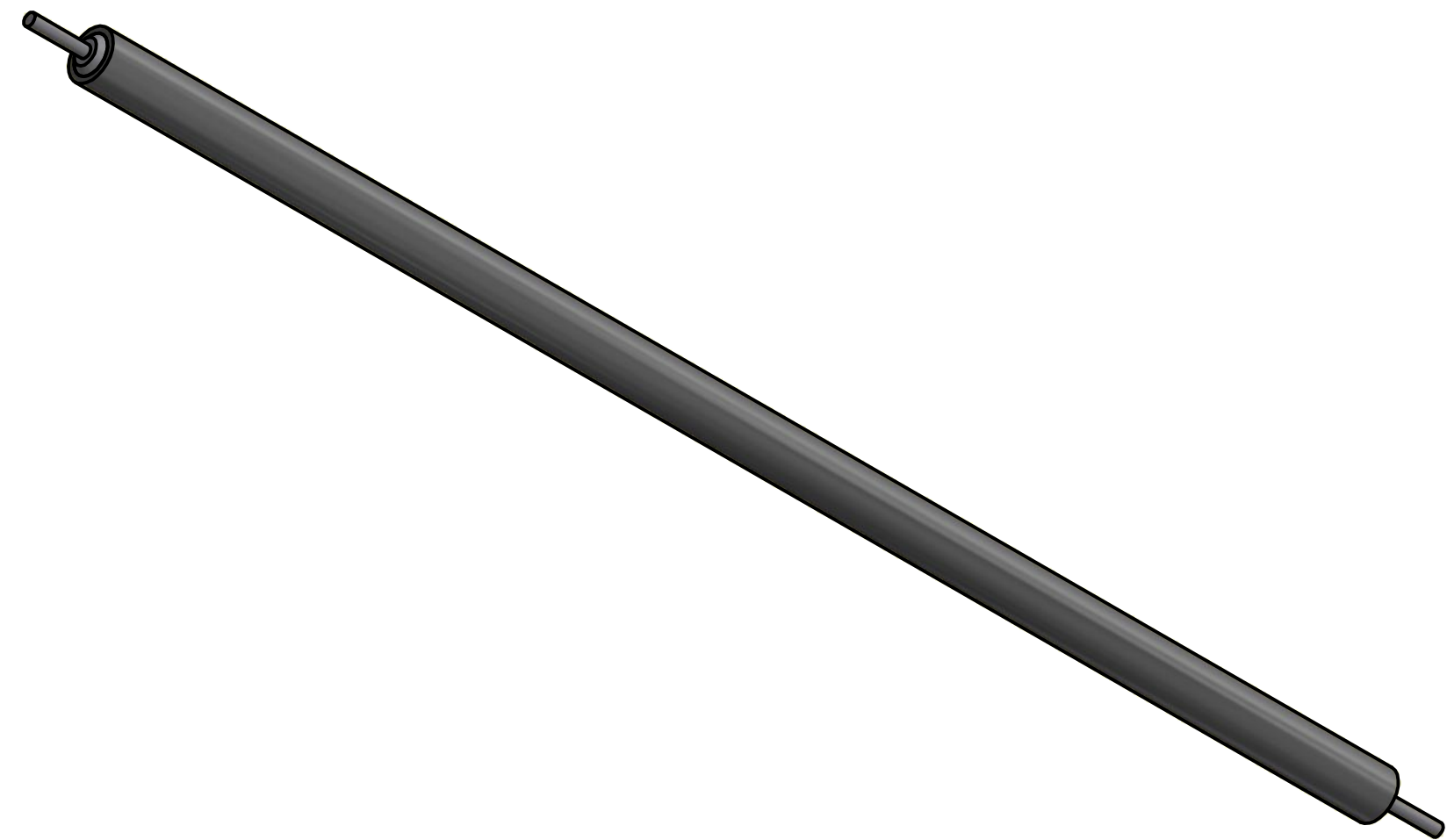
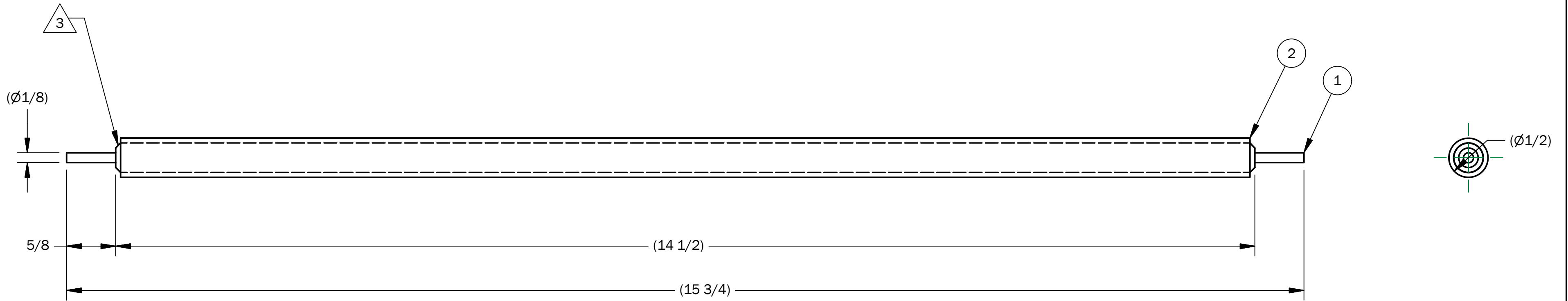

| ITEM | QTY | PART NO. | DESCRIPTION |
|------|-----|----------|--|
| 2 | 1 | 0910-012 | TUBING, RUBBER, SILICONE, 7/16 OD x 5/16 ID, BLACK |
| 1 | 1 | 6010-318 | ROLLER CORE, CHAIN - CONVEYOR |

Material Specification

| | | | | |
|---|---|-----------------------|--|--|
| ALL DIMENSIONS IN INCHES EXCEPT WHERE NOTED | DWG BY: GOEBEL | | HEAT SEAL/AMPAK CLEVELAND, OHIO 44125 | |
| | DATE: 3/11/1992 | | | |
| STANDARD TOLERANCES EXCEPT WHERE NOTED (ALL PLUS/MINUS) | CHK'D BY: | | DESCRIPTION: ROLLER ASSY, CHAIN - CONVEYOR | |
| | DATE: | | | |
| 2 PLC. DECIMAL: .010 | USED ON: T-3417 LDR TUNNEL CONV. | | DRAWING NO. | |
| 3 PLC. DECIMAL: .005 | SHEET SIZE: C | SHEET: 1 OF: 1 | 6007-432 | |
| FRACTION: 1/32 | DO NOT SCALE PRINT | | | |
| ANGLE: 1' | PART FILE NAME: I:\CAD\HEATSEAL\PRODUCTS\TUNNELS\T-3417\6007\6007-432.iam | | | |