

2 PLACES

2 PLACES
G

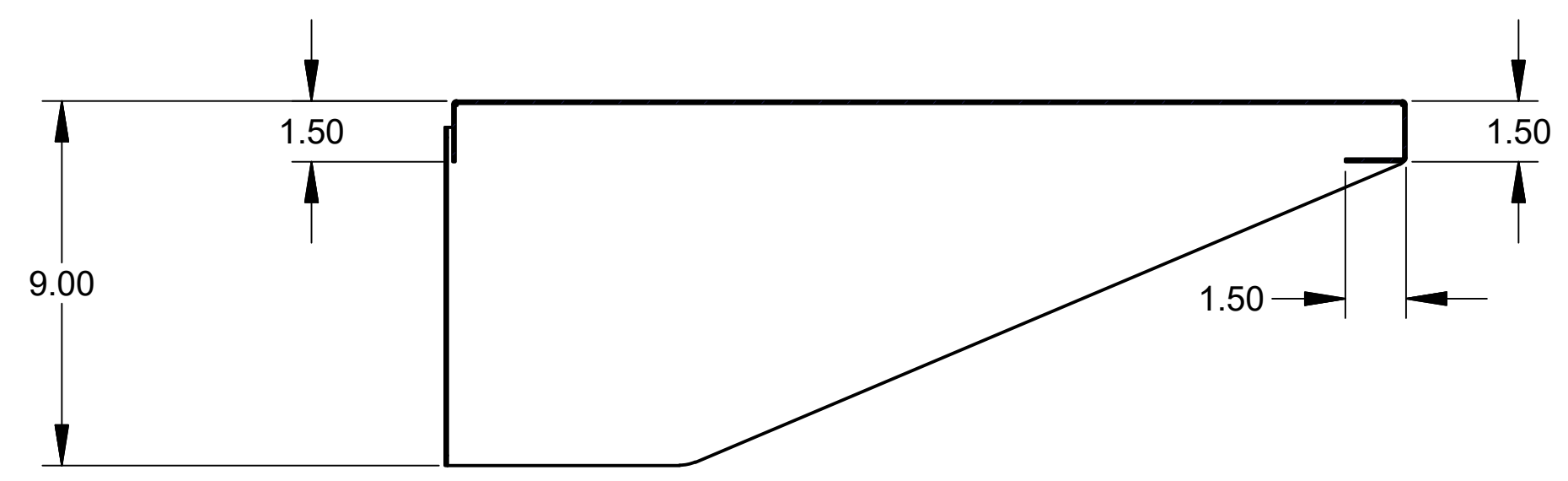
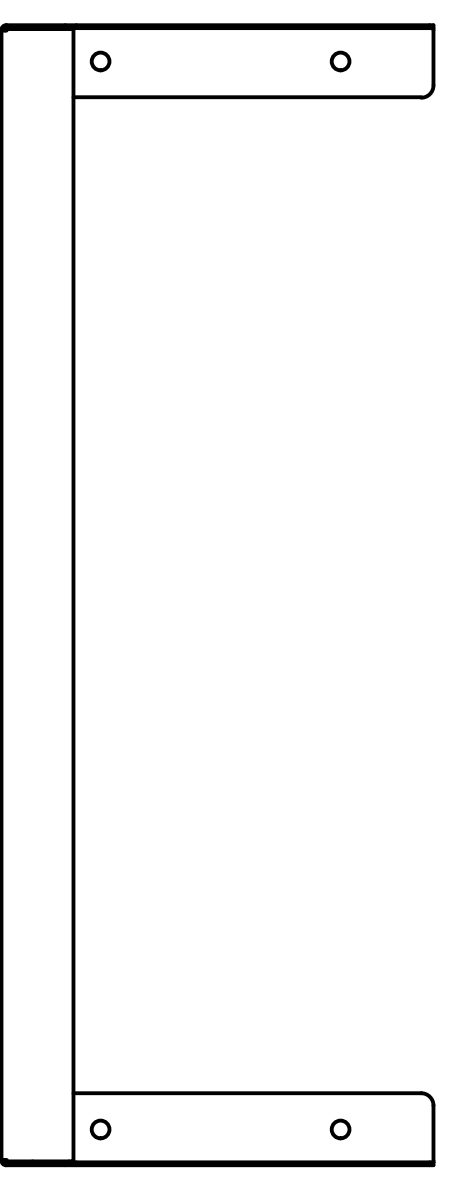
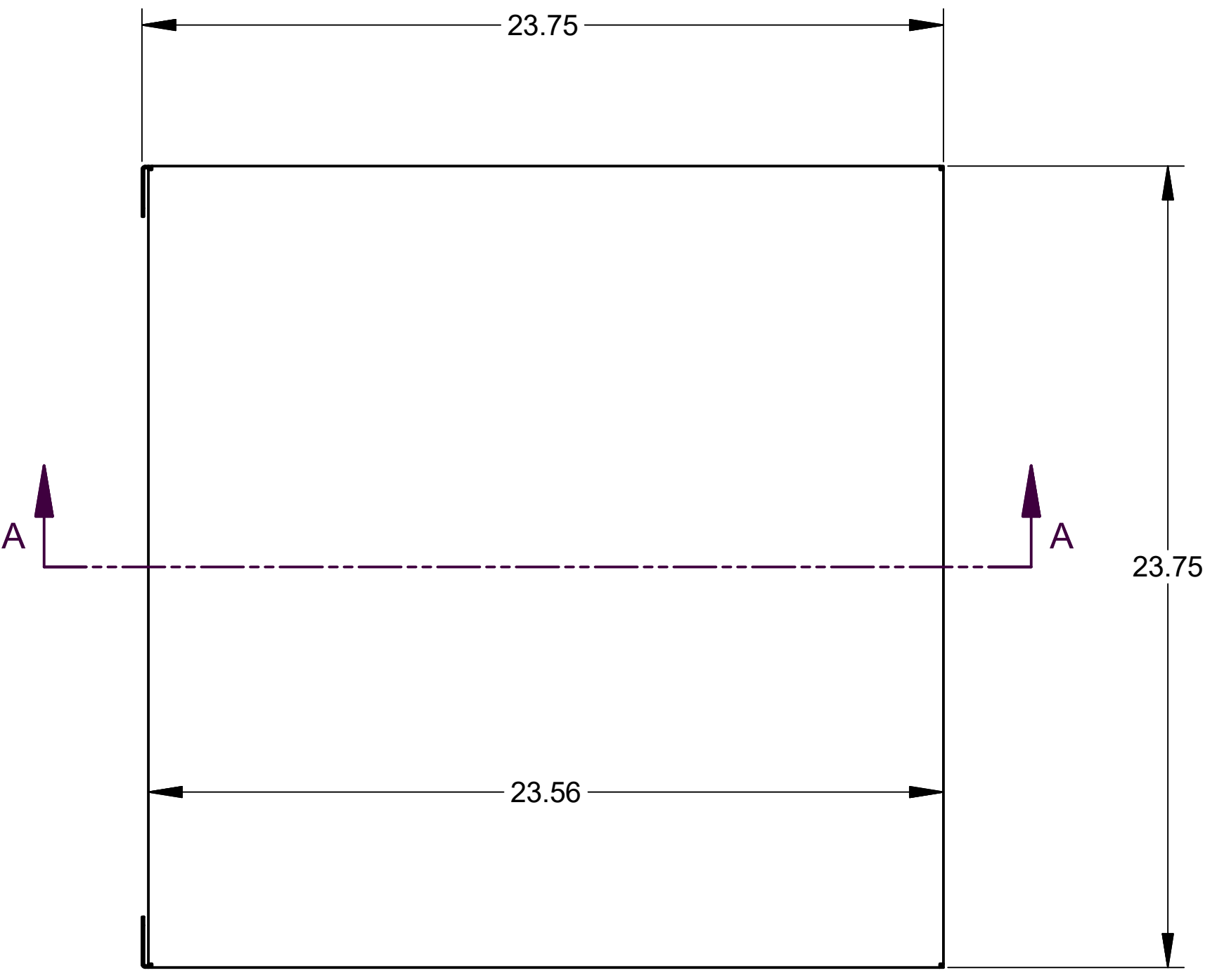
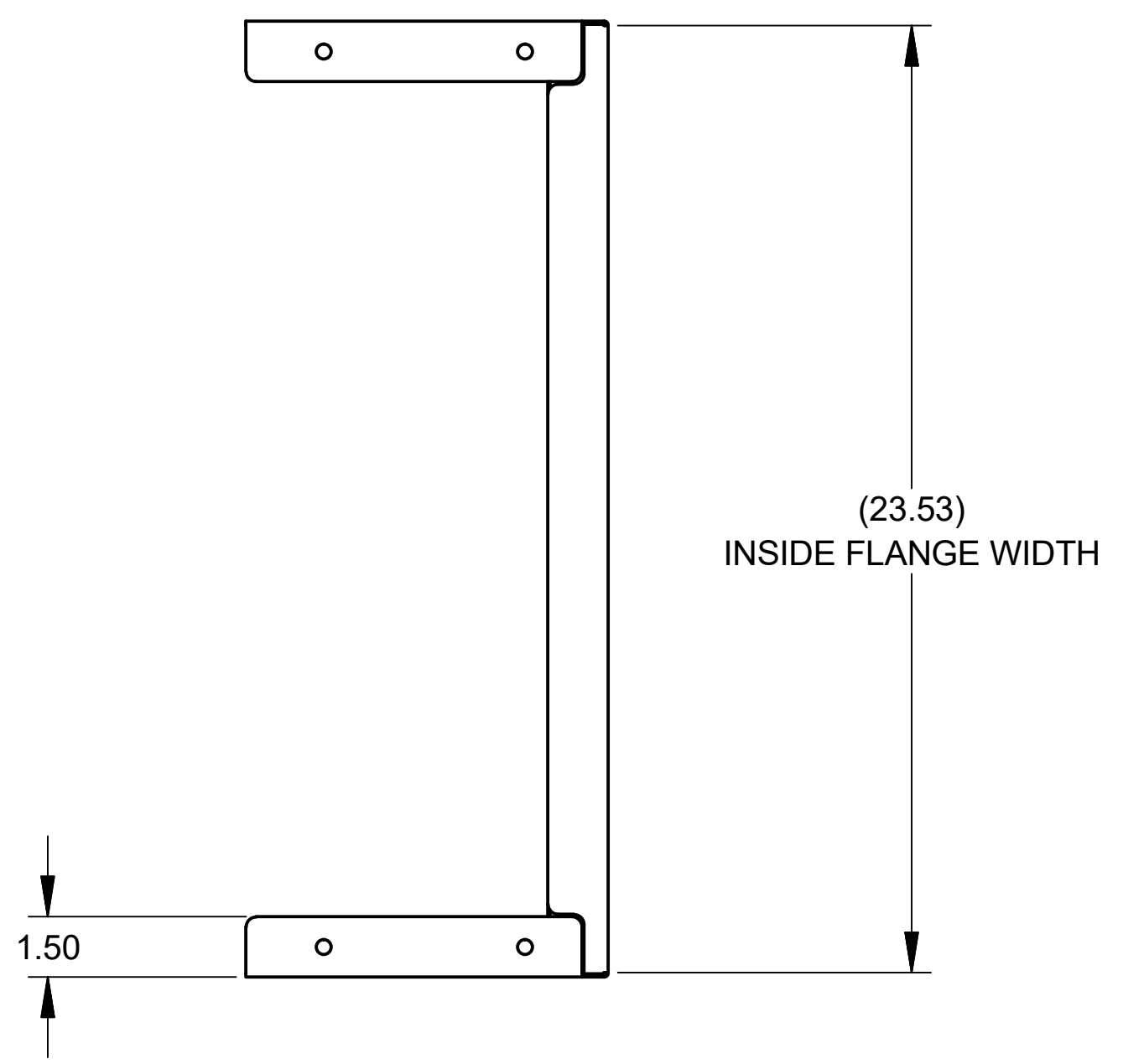
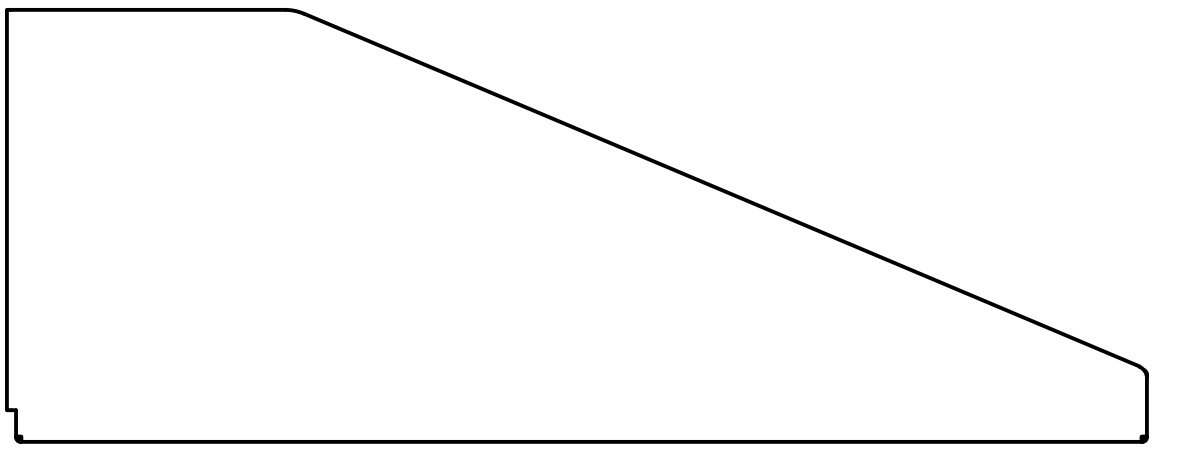
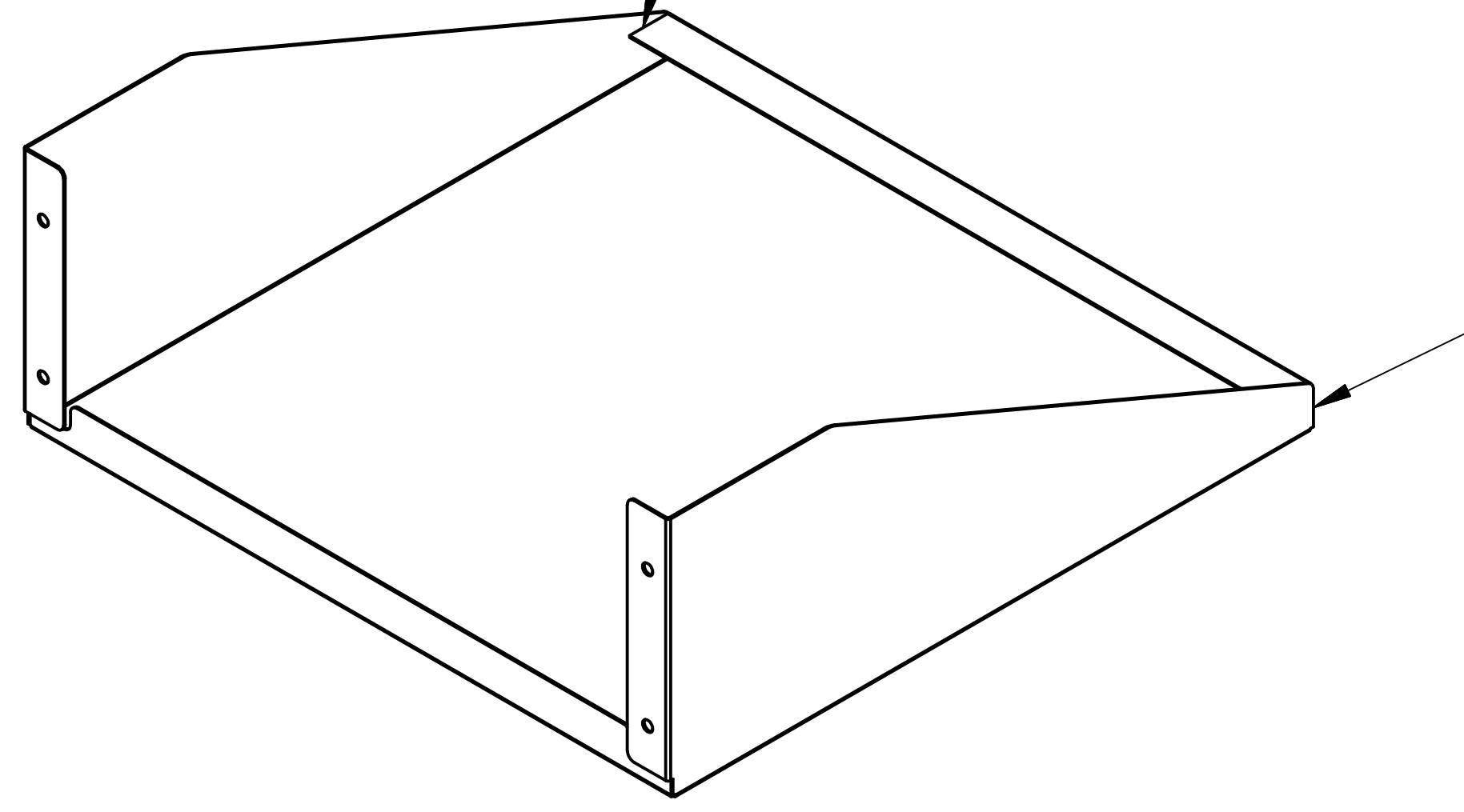

SECTION A-A

ALL NOTES BELOW APPLY UNLESS OTHERWISE SPECIFIED:

1. REMOVE ALL BURRS AND SHARP EDGES
2. WELD AS NOTED
3. FINISH: GRIND ALL WELDS AND EDGES SMOOTH, MATCH GRAIN

CONFIDENTIAL
THIS PRINT IS PROPERTY OF, AND DISCLOSES PROPRIETARY INFORMATION OF HEAT SEAL. IT IS LOANED FOR REFERENCE ONLY, AND MAY NOT BE REPRODUCED OR FORWARDED ELECTRONICALLY IN ANY MANNER, OR ITS CONTENTS DISCLOSED TO OTHERS, WITHOUT THE EXPLICIT WRITTEN PERMISSION OF OWNER AND MUST BE DESTROYED UPON REQUEST.

3910-010	SHEET, SS, 16GA, 304/NO, 3POL/PVC	41.56 X 27.96
Stock No.	Material Description	BLANK SIZE
Material Specification		
HEAT SEAL/AMPAK CLEVELAND, OHIO 44125		
UNLESS OTHERWISE SPECIFIED:	CREATED: 7/7/2017	DESCRIPTION: 2FT. OUTFEED TABLE, TP/SP
ALL DIMENSIONS IN INCHES	CREATED BY: MABBOTT	DRAWING NUMBER: 8704-312
STANDARD TOLERANCES:	CHECKED:	REVISION: 0
0.00: ± .030	CHECKED BY:	SIZE: D SCALE: NONE SHEET: 1 OF: 1
0.000: ± .005		
ANGLE: ± 1'		