

ITEM	QTY	PART NUMBER	DESCRIPTION
42	20	1909-008	WASHER, FENDER, SS, .875 OD X .25 ID X .075 THK
41	10FT	0910018	U CHANNEL, EDGE MOLDING, BLACK
40	1	1839-071	GEARMOTOR, 90VDC, 42RPM, 166IN-LBS
39	1	1851-051	Power Cord 3-16, SJT, 84 IN. LG.
38	1	1863-001	SPEED CONTROL, CONVEYOR
37	2	1869-043	CORD GRIP, NYLON, 1/2 NPT, 0.18-.4 DIA
36	2	1869-052	1/2 NPT LOCKNUT
35	34	1903-045	SCR, CAP, HEX HD, SS, 1/4-20 X 3/4 LG
34	56	1903-169	SCR, CAP, BUTTON HD, SOCKET 1/4-20 X 5/8 LG, SS
33	16	1903-180	SCR, CAP, HEX HD, SS, 1/4-20 X 2 LG, W/ 3/4 THD
32	10	1903-275	SCR, MACH, PAN HD, PHIL, SS, #8-32 X 1/2 LG
31	4	1903-291	SCR, CAP, SOCKET HD, 1/4 -28 X 3/4, SS
30	4	1903-633	SCR, FLAT HD, SS, SOCKET, 1/4-20 x 1.5 LG
29	4	1903-731	SCR, CAP, HEX HD, SS, 3/8-16 X 2, PARTIAL THD
28	108	1907-001	LOCKWASHER, SPLIT, 1/4 MED, SS
27	4	1907-009	LOCKWASHER, SPLIT, 3/8
26	10	1907-012	LOCKWASHER, SPLIT, #8 MED, SS
25	112	1909-002	WASHER, FLAT, SS, 5/8 OD X 1/4 ID X .065 THK
24	8	1909-009	WASHER, FLAT, 3/8, .406 ID X .812 OD X .065
23	10	1909-039	WASHER, FLAT, #8, SS
22	4	1911-004	NUT, HEX, FINISHED, 3/8-16 SS
21	32	1911-010	NUT, HEX, 1/4-20 SS
20	6	1911-021	NUT, HEX, NYLOCK 1/4-20, SS
19	2	2105-034	BEARING, FLG MT, SQ, 1" BORE, 2.75" HOLE SPCNG
18	4	2115-001	CASTER, SWIVEL, STEM TYPE, 3" W/BRAKE
17	4	2115-022	INSERT, CASTER
16	4	2125-015	CASTER, SWIVEL 3", POLYPROPYLENE, 270#
15	4	2135-041	LEVELER, SWIVEL, 1/2-13x5" STEM, 3.15" DIA FOOT
14	1	2175-047	SPROCKET, ROLLER CHAIN #41, 41B11, 5/8 BORE, W/KW & SS
13	8	6510-069	SHIM, 16GA, 2125015 CASTER
12	1	6510-234	FRAME WELDMENT, ACCUMULATOR PWR TBL
11	2	6510-235	LEG WELDMENT, AT
10	1	6510-236	DRIVE SHAFT WELDMENT, AT
9	1	6510-237	ELECTRICAL PANEL WELDMENT, AT
8	2	6510-240	LEG JOINING PLATE, AT
7	2	6510-241	CASTER MOUNT PLATE, AT
6	1	6510-242	DRIVE MOUNT PLATE, AT
5	3	6510-243	SIDE PANEL, AT
4	1	6510-244	DRIVE CHAIN ASSY, AT
3	1	6510-245	WIRING DIAGRAM, ACCUMULATOR TABLE
2	1	6510-246	ELECTRICAL COVER PANEL ASSY, AT, 115V
1	1	6510-248	ACCUMULATOR TABLE ASSY, 36", 4" RIM

Material Specification

HEAT SEAL/AMPAK
CLEVELAND, OHIO 44125

<p>CONFIDENTIAL THIS PRINT IS PROPERTY OF, AND DISCLOSES PROPRIETARY INFORMATION OF HEAT SEAL. IT IS LOANED FOR REFERENCE ONLY, AND MAY NOT BE REPRODUCED OR FORWARDED ELECTRONICALLY IN ANY MANNER, OR ITS CONTENTS DISCLOSED TO OTHERS, WITHOUT THE EXPLICIT WRITTEN PERMISSION OF OWNER AND MUST BE DESTROYED UPON REQUEST.</p>	UNLESS OTHERWISE SPECIFIED:	CREATED: 10/29/2020	DESCRIPTION: ACCUMULATING POWER TABLE, 36", 4" RIM, 115V	
	ALL DIMENSIONS IN INCHES	CREATED BY: MABBOTT	DRAWING NUMBER: AT-361R4XA	
	STANDARD TOLERANCES:	CHECKED:	REVISION: 0	
	0.00: ± .010 0.000: ± .005 ANGLE: ± 1'	CHECKED BY:	SIZE: D	SCALE: NONE

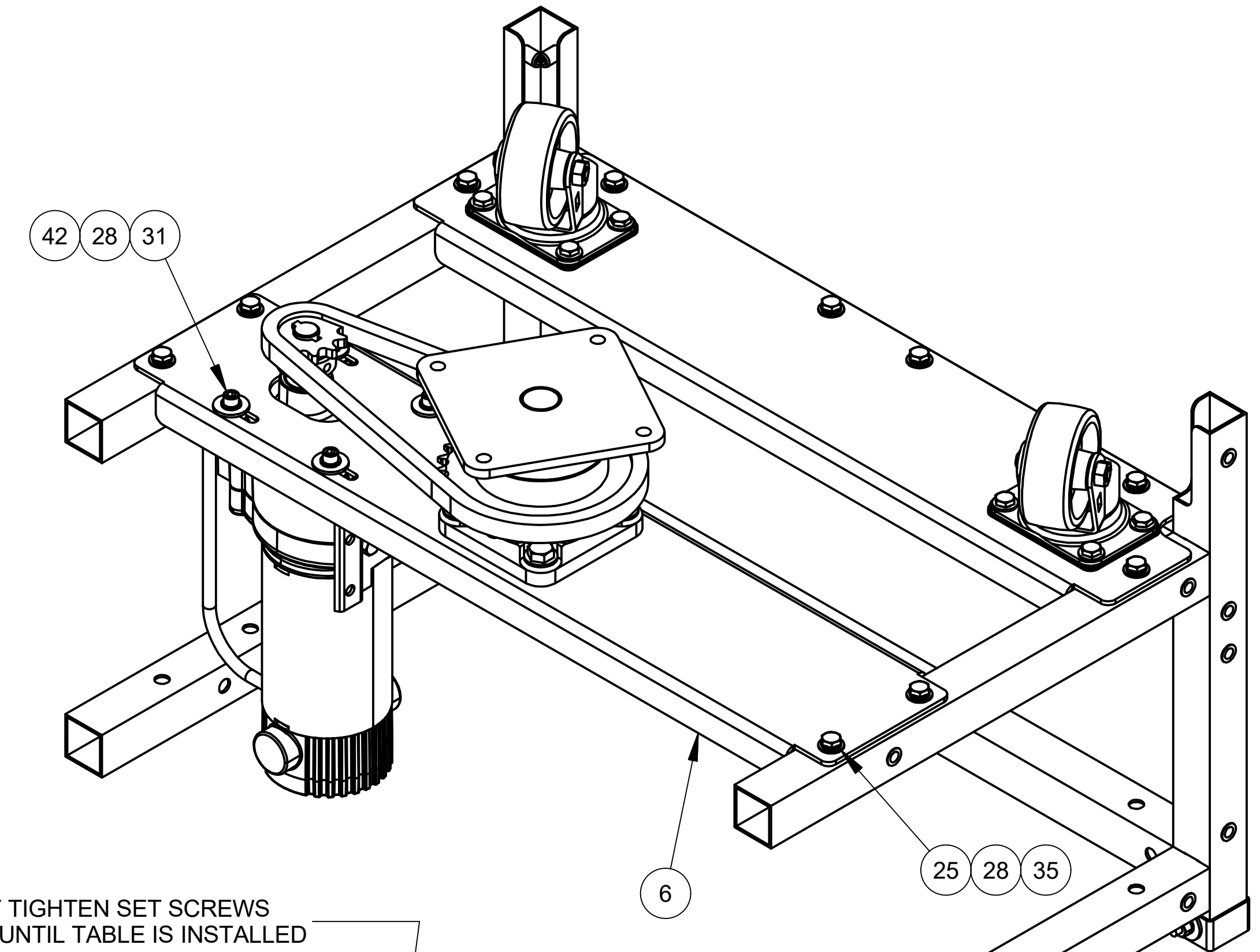
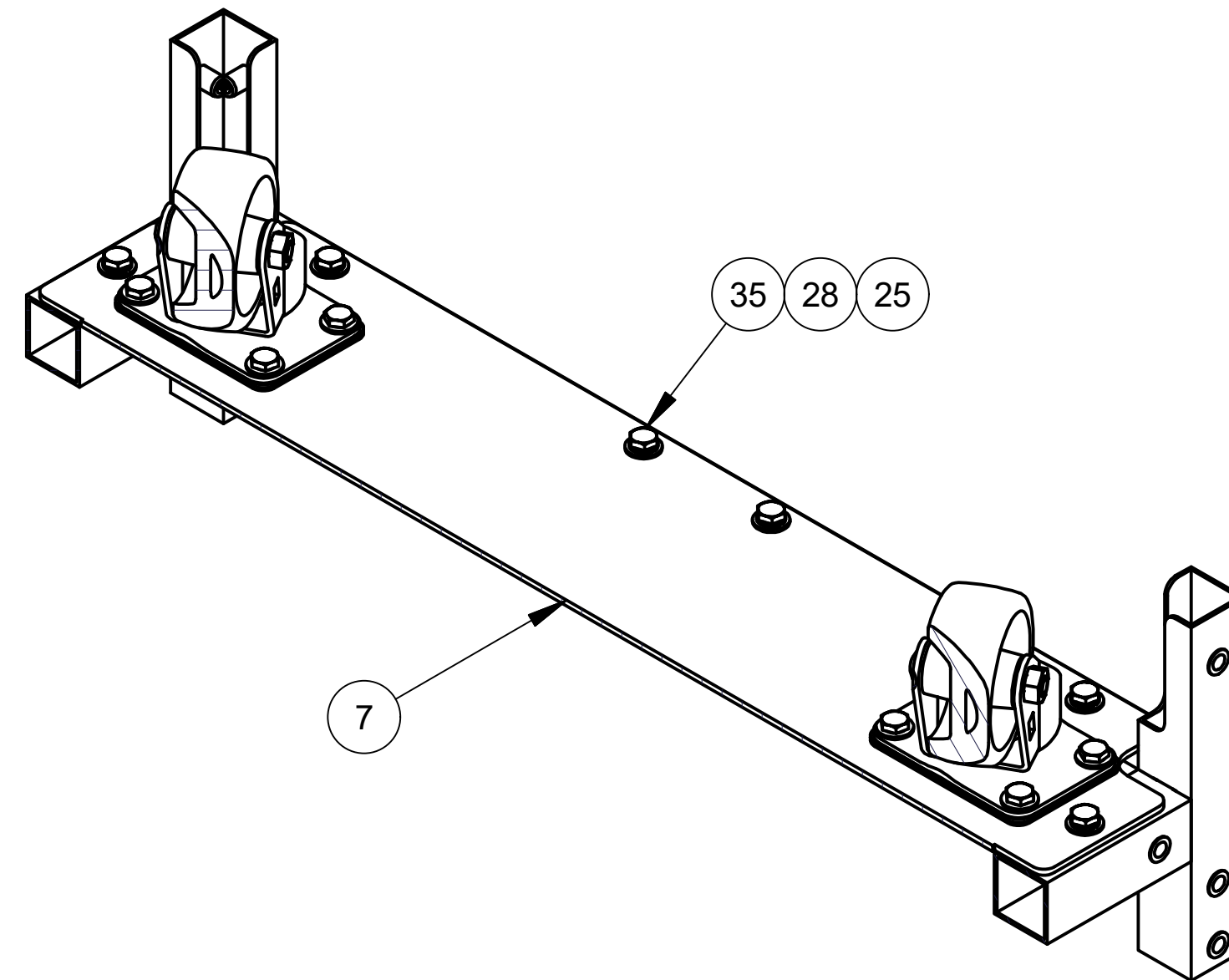
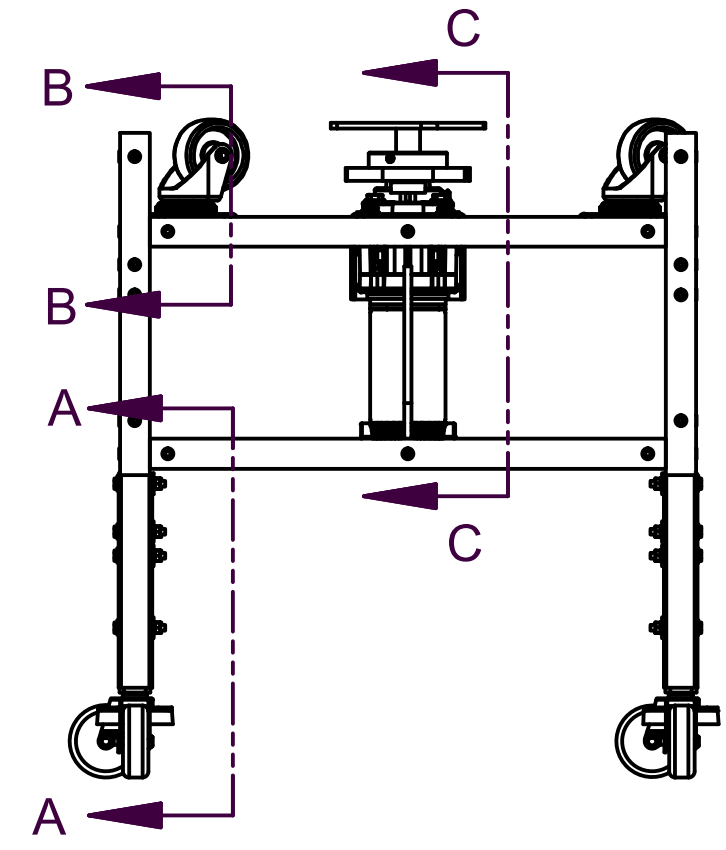
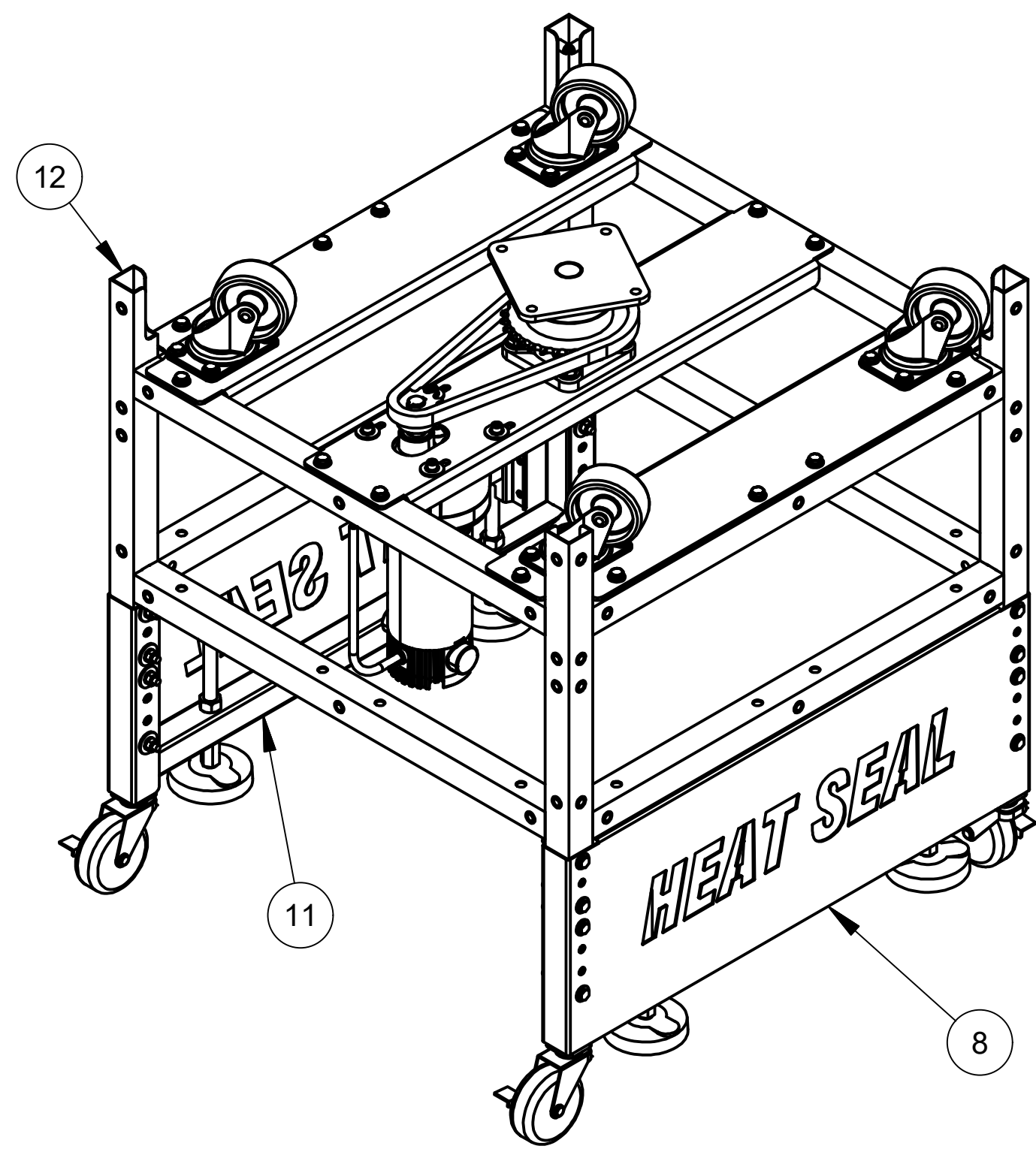

DO NOT TIGHTEN SET SCREWS ON SHAFT UNTIL TABLE IS INSTALLED

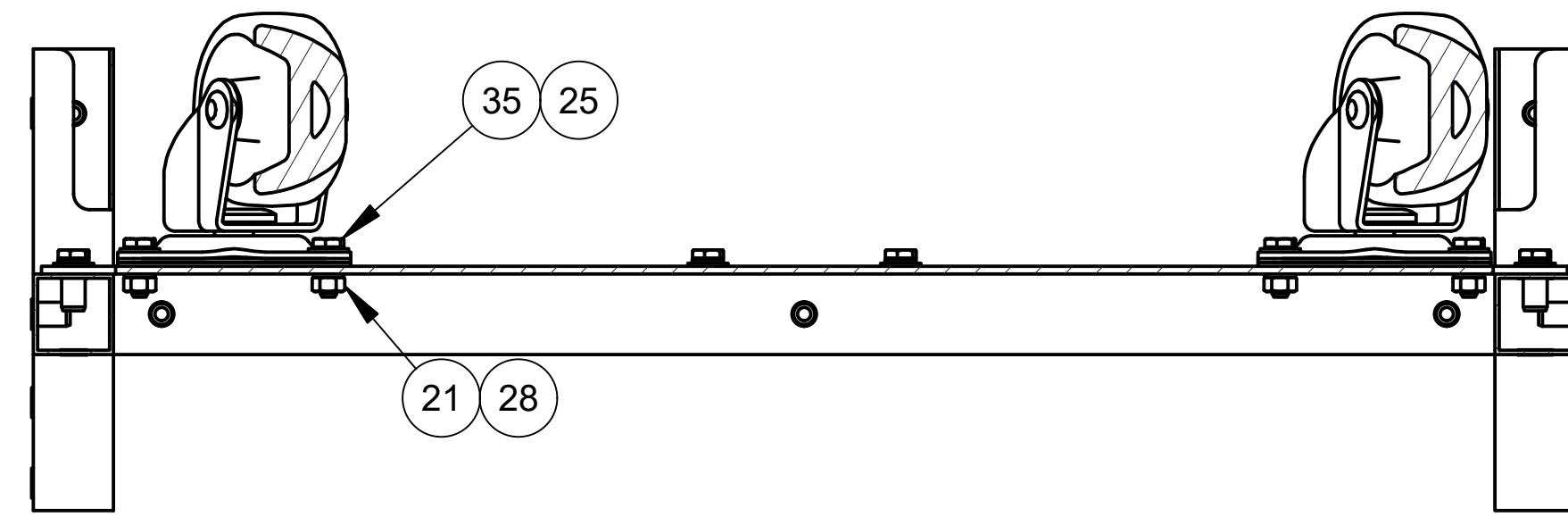

SECTION B-B

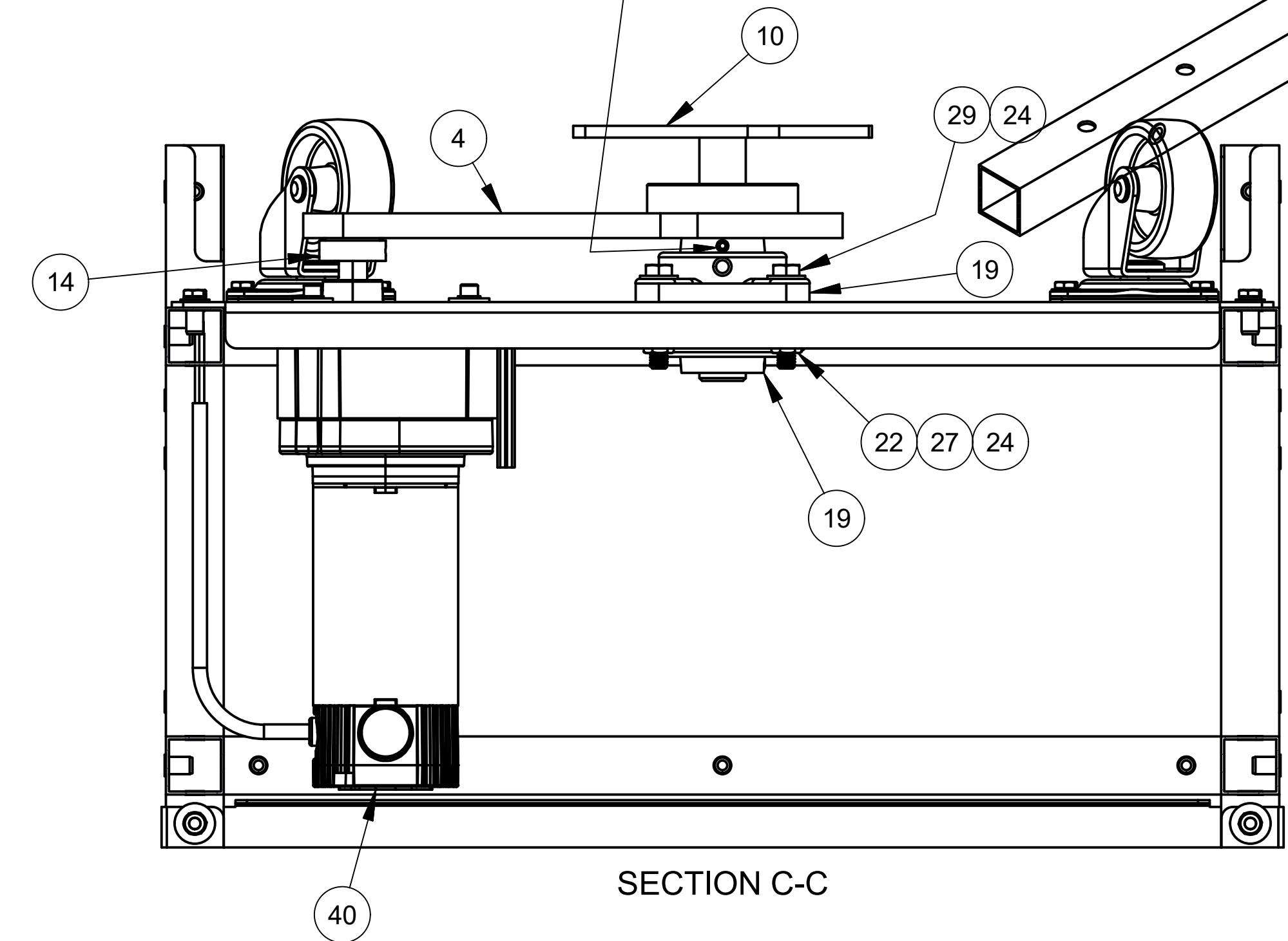

SECTION C-C

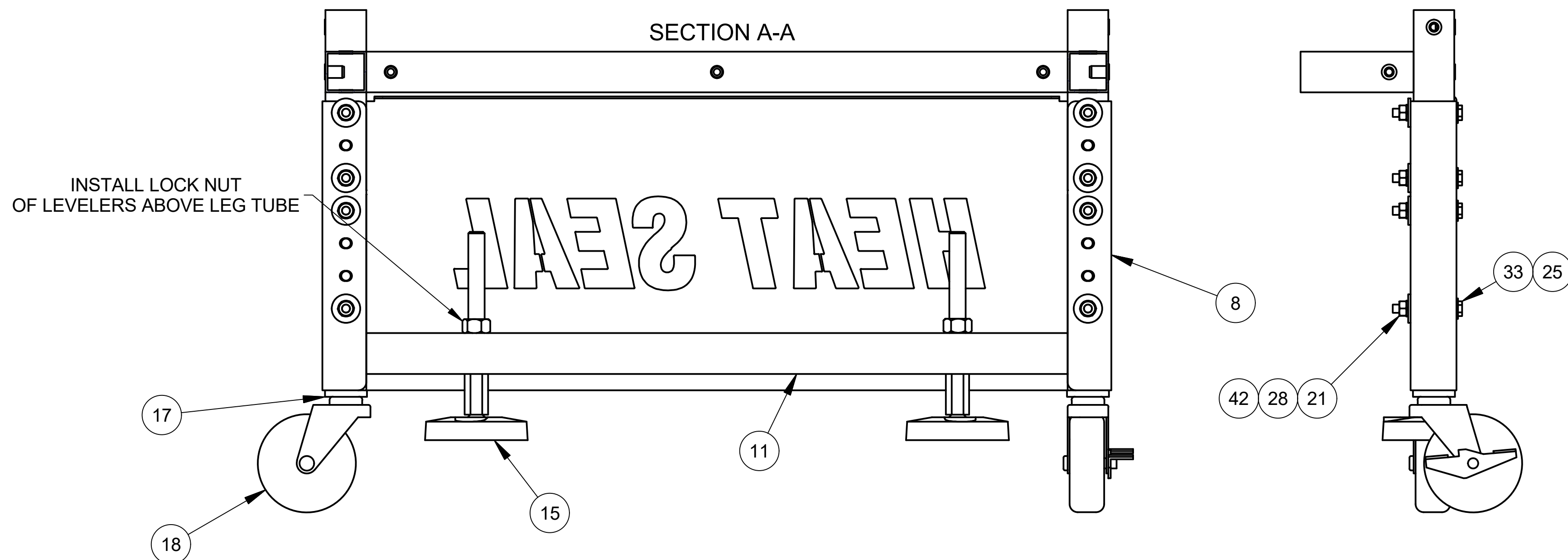

SECTION A-A

HEAT SEAL/AMPAK
CLEVELAND, OHIO 44125

CONFIDENTIAL
THIS PRINT IS PROPERTY OF, AND DISCLOSES PROPRIETARY INFORMATION OF HEAT SEAL. IT IS LOANED FOR REFERENCE ONLY, AND MAY NOT BE REPRODUCED OR FORWARDED ELECTRONICALLY IN ANY MANNER, OR ITS CONTENTS DISCLOSED TO OTHERS, WITHOUT THE EXPLICIT WRITTEN PERMISSION OF OWNER AND MUST BE DESTROYED UPON REQUEST.

DESCRIPTION:
ACCUMULATING POWER TABLE, 36", 4" RIM, 115V

DRAWING NUMBER:
AT-361R4XA

REVISION:
0

SIZE: D SCALE: NONE SHEET: 2 OF: 5

8 7 6 5 4 3 2 1

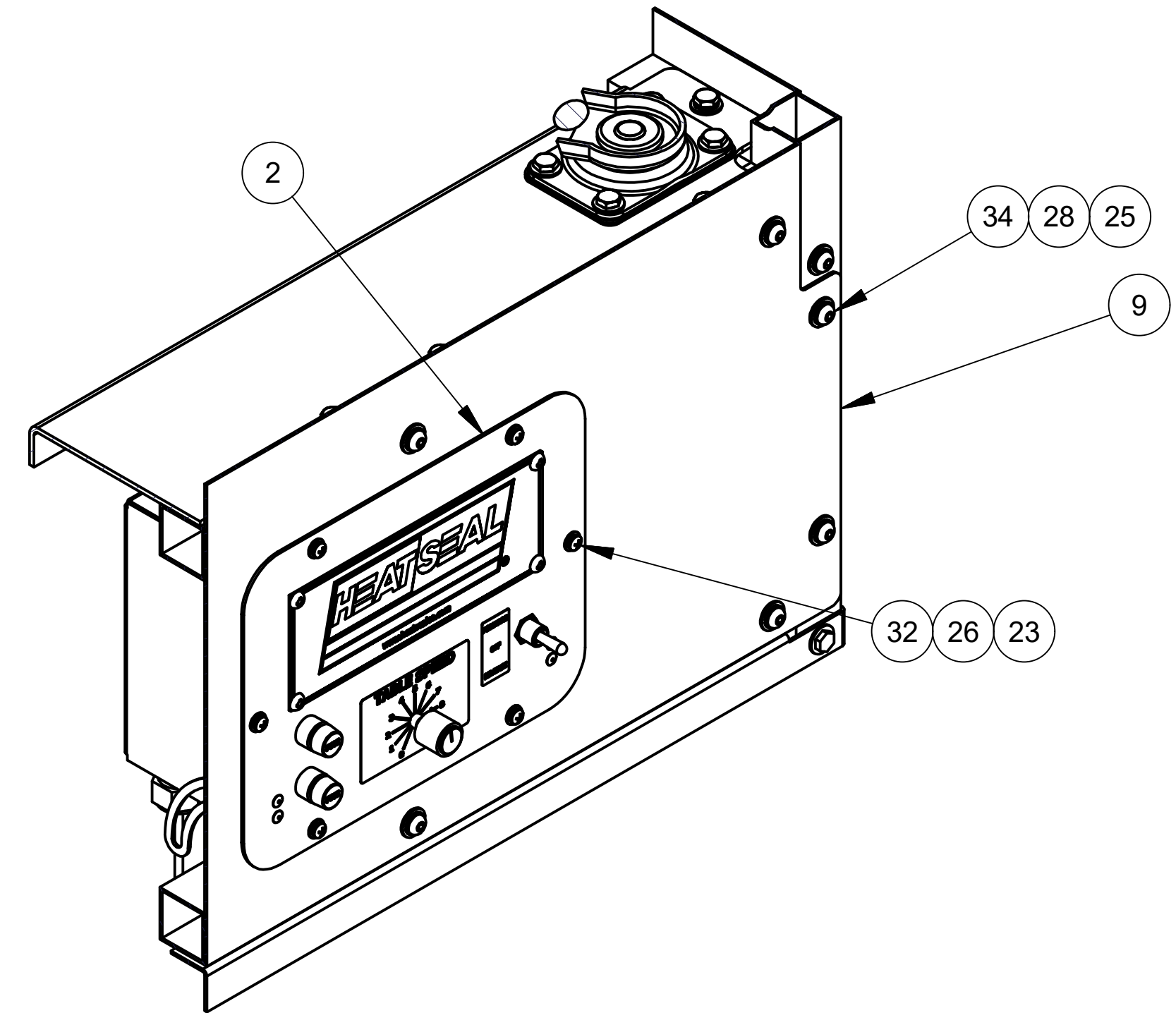
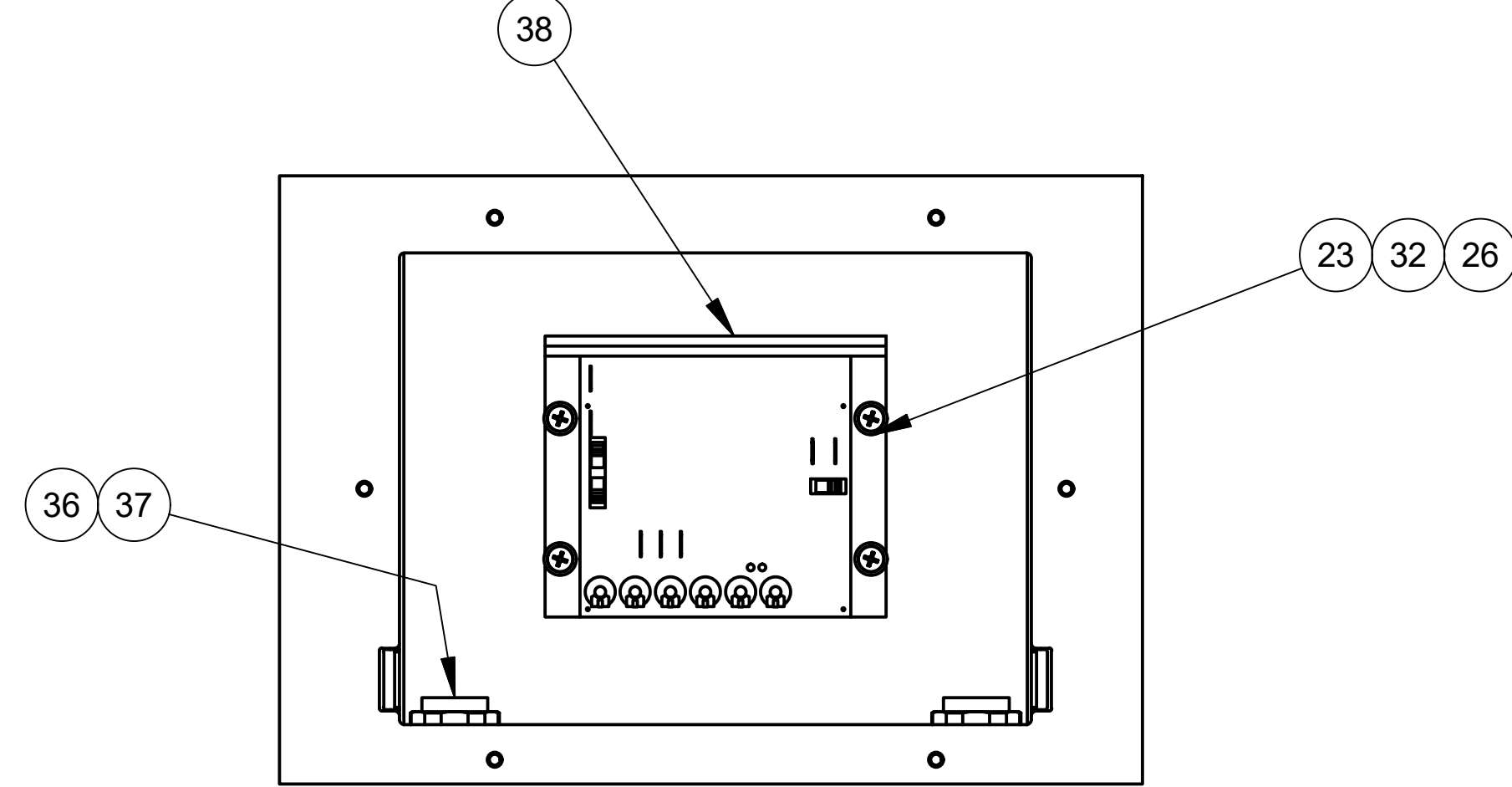
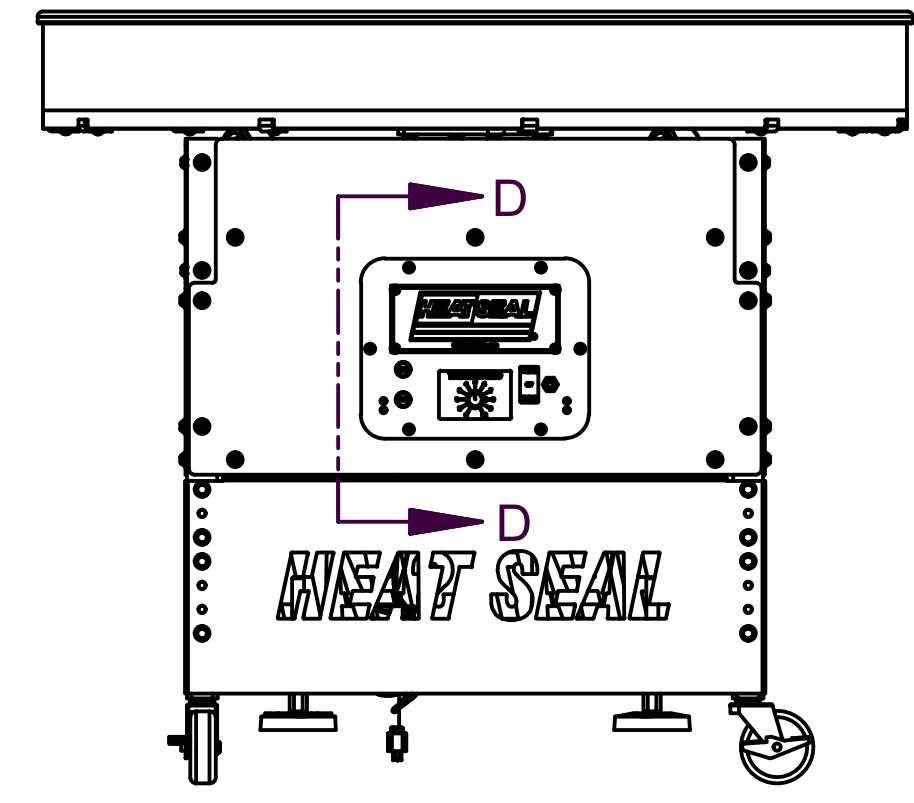

TYP ALL UNUSED RIVNUTS

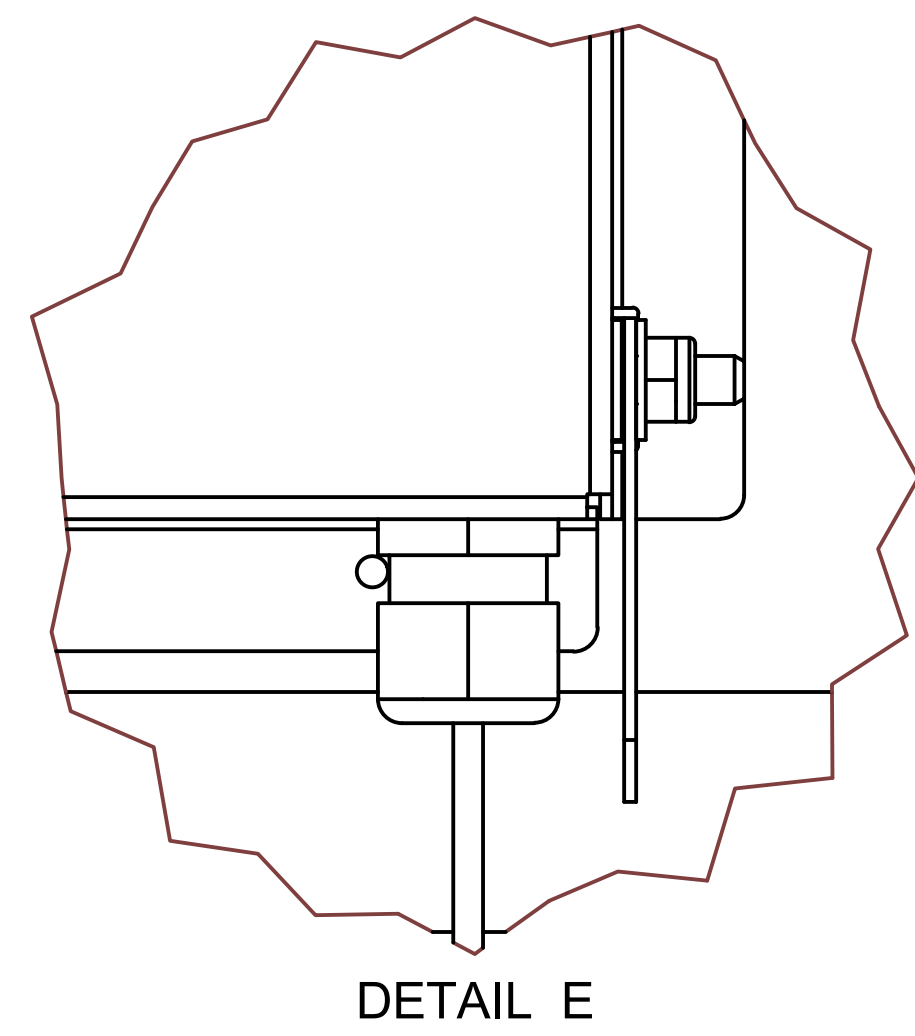
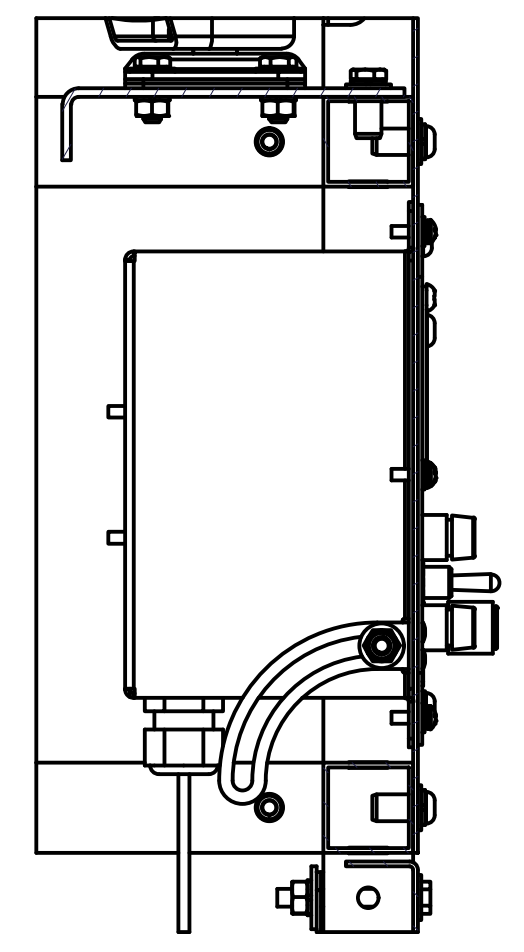
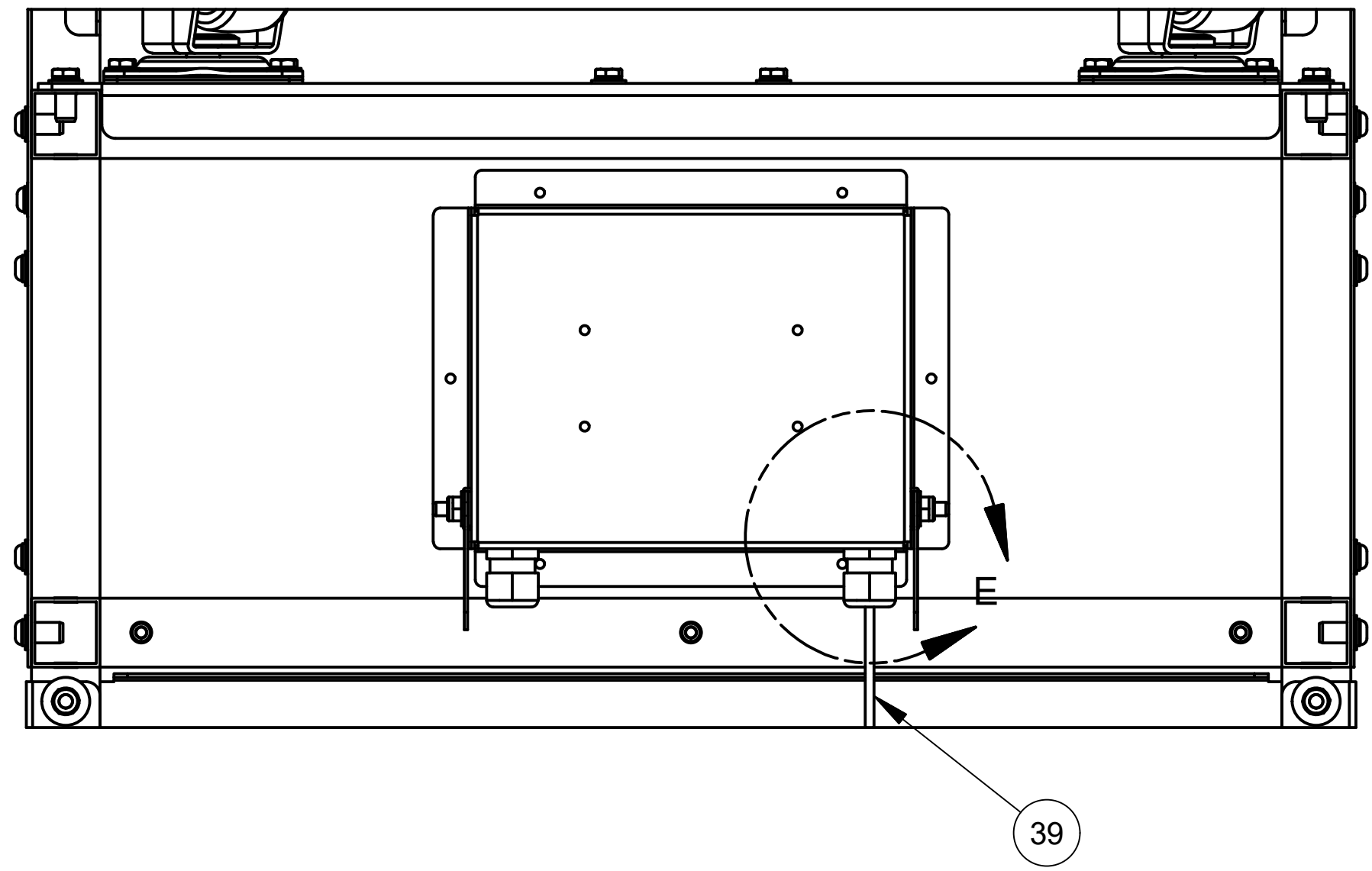
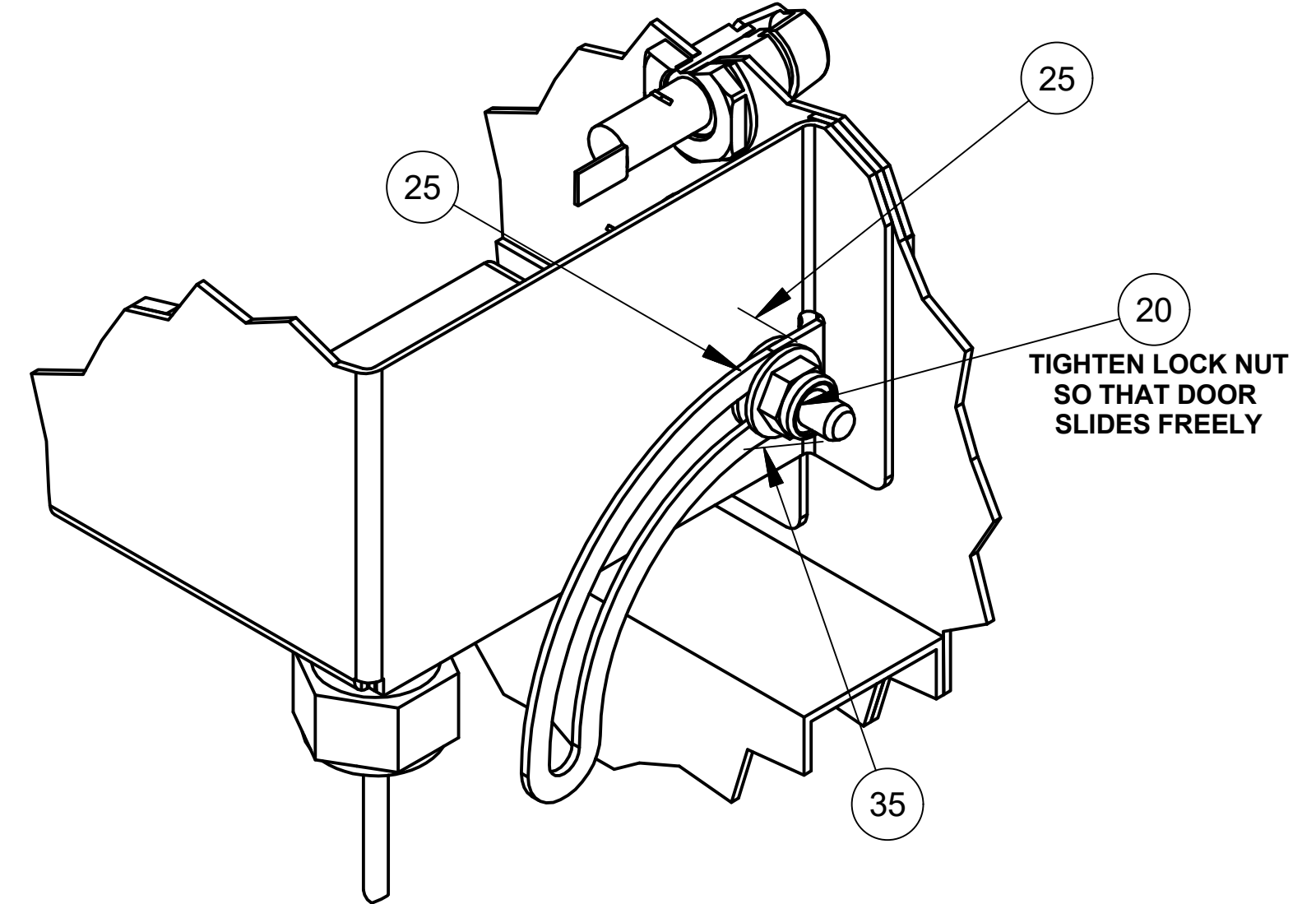

HEAT SEAL/AMPAK CLEVELAND, OHIO 44125			
CONFIDENTIAL THIS PRINT IS PROPERTY OF, AND DISCLOSES PROPRIETARY INFORMATION OF HEAT SEAL. IT IS LOANED FOR REFERENCE ONLY, AND MAY NOT BE REPRODUCED OR FORWARDED ELECTRONICALLY IN ANY MANNER, OR ITS CONTENTS DISCLOSED TO OTHERS, WITHOUT THE EXPLICIT WRITTEN PERMISSION OF OWNER AND MUST BE DESTROYED UPON REQUEST.	DESCRIPTION: ACCUMULATING POWER TABLE, 36", 4" RIM, 115V		REVISION:
	DRAWING NUMBER: AT-361R4XA		0
	SIZE: D	SCALE: NONE	SHEET: 3

8 7 6 5 4 3 2 1

COUNTER SINK
HOLES IN PLATE

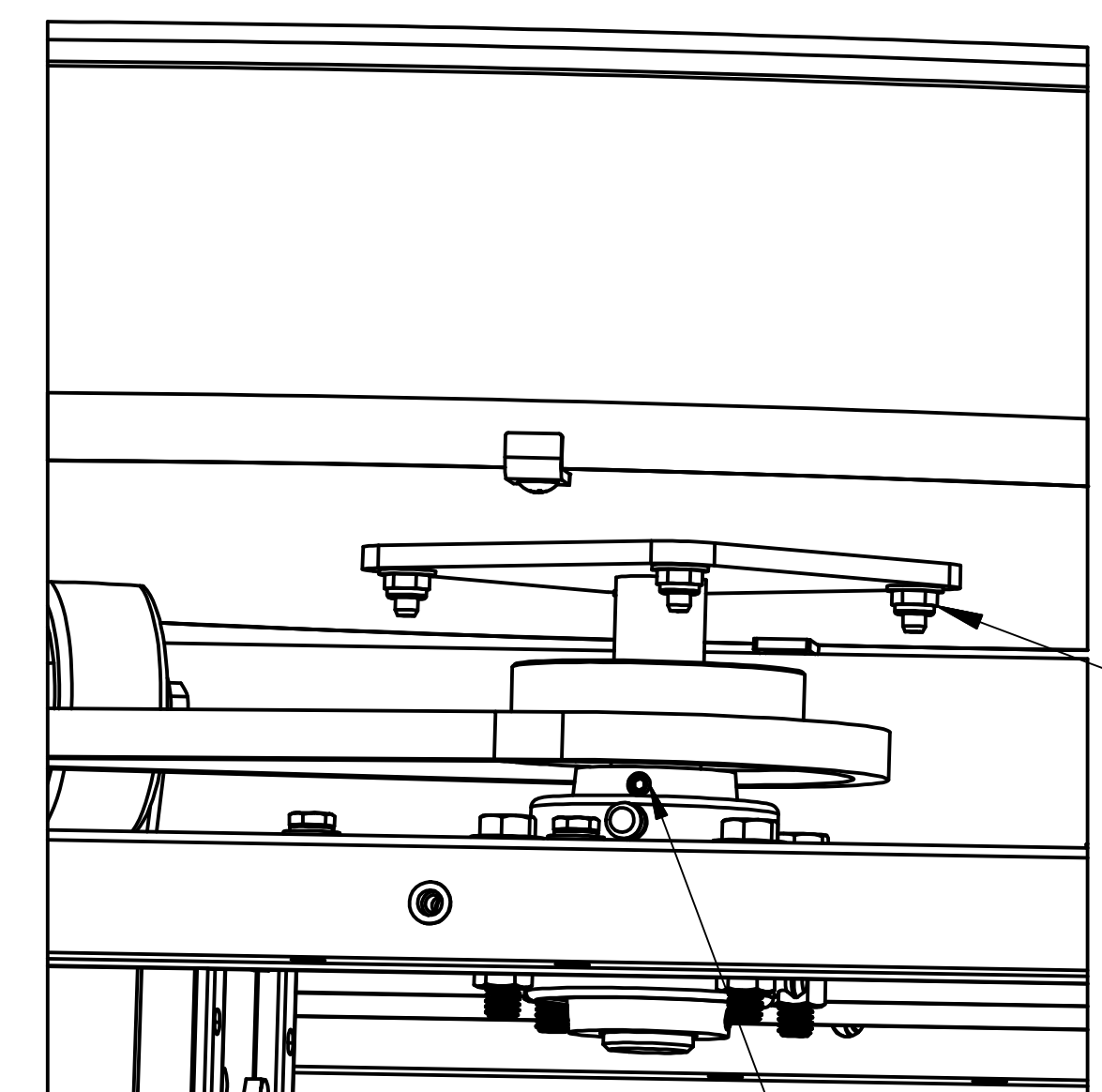
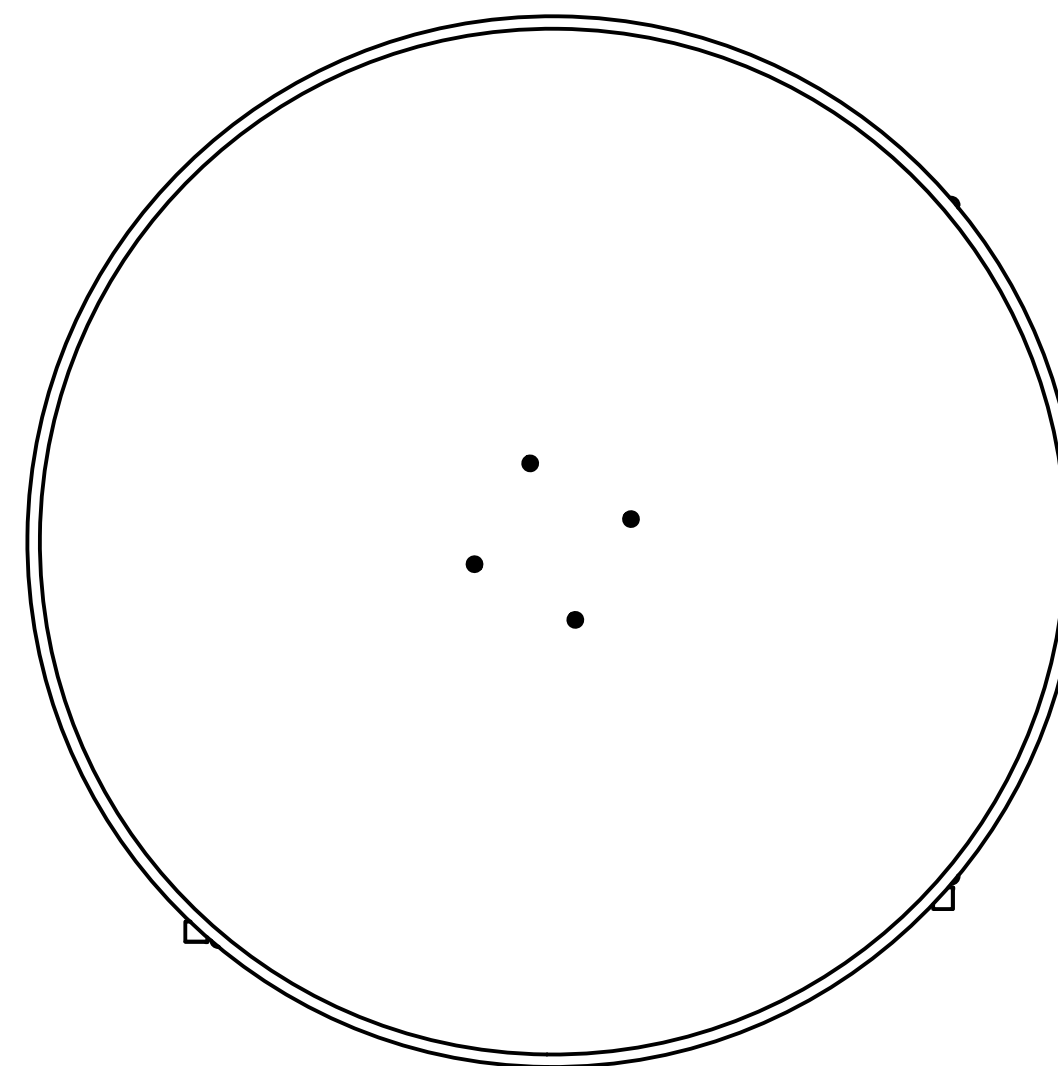
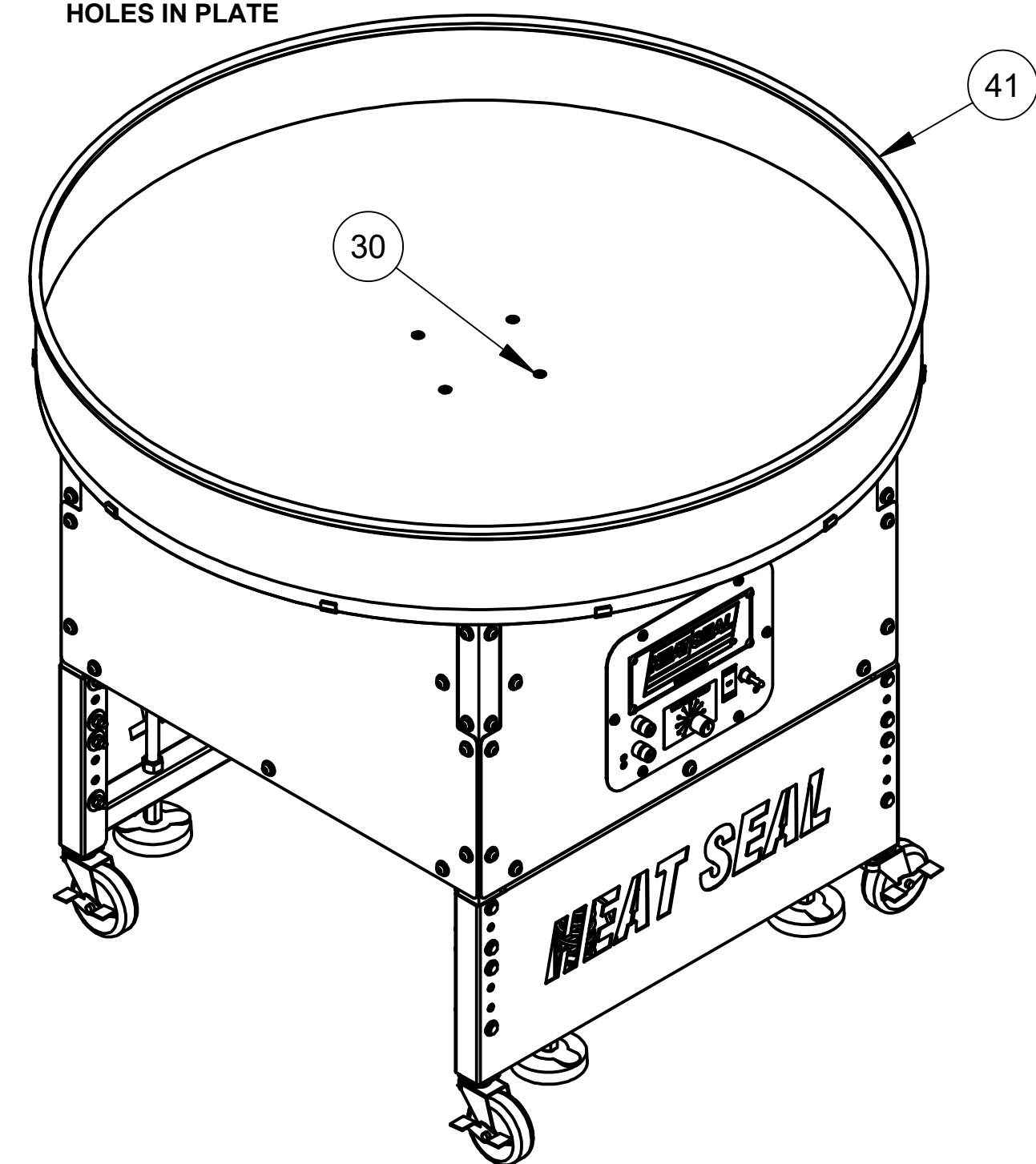

TIGHTEN SET SCREW
WITH TABLE INSTALLED.
MAKE SURE SPROCKETS
ARE LEVEL WITH EACH OTHER.

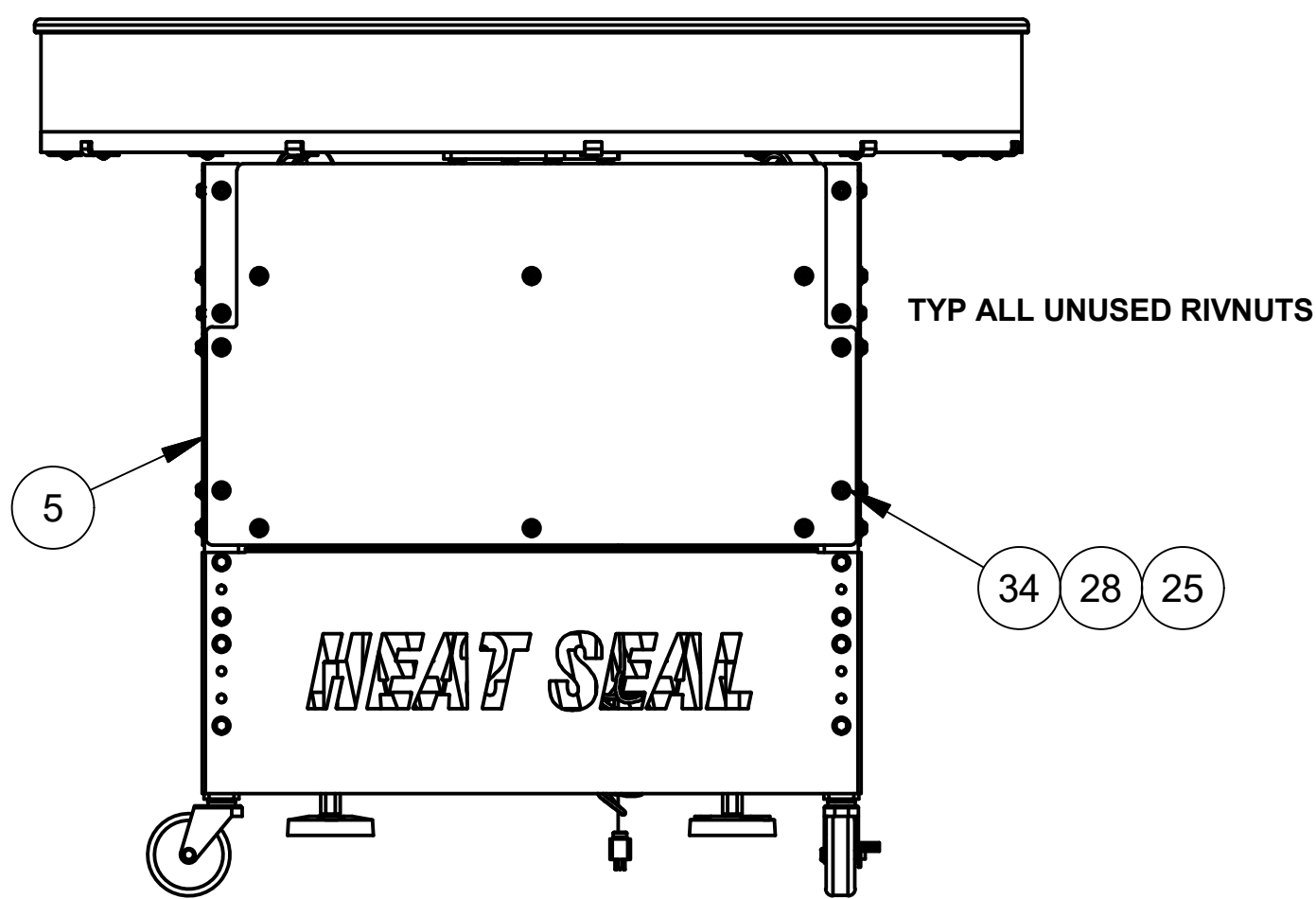

TYP ALL UNUSED RIVNUTS

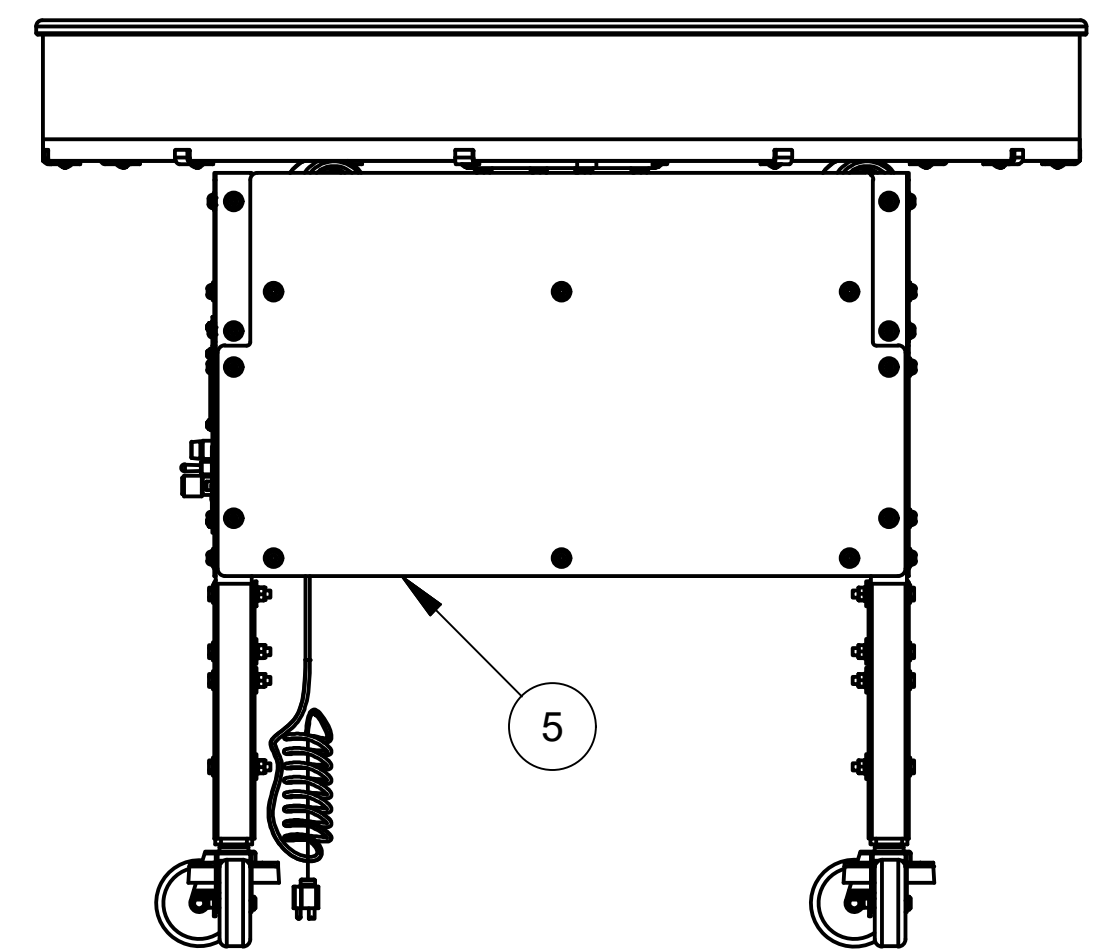
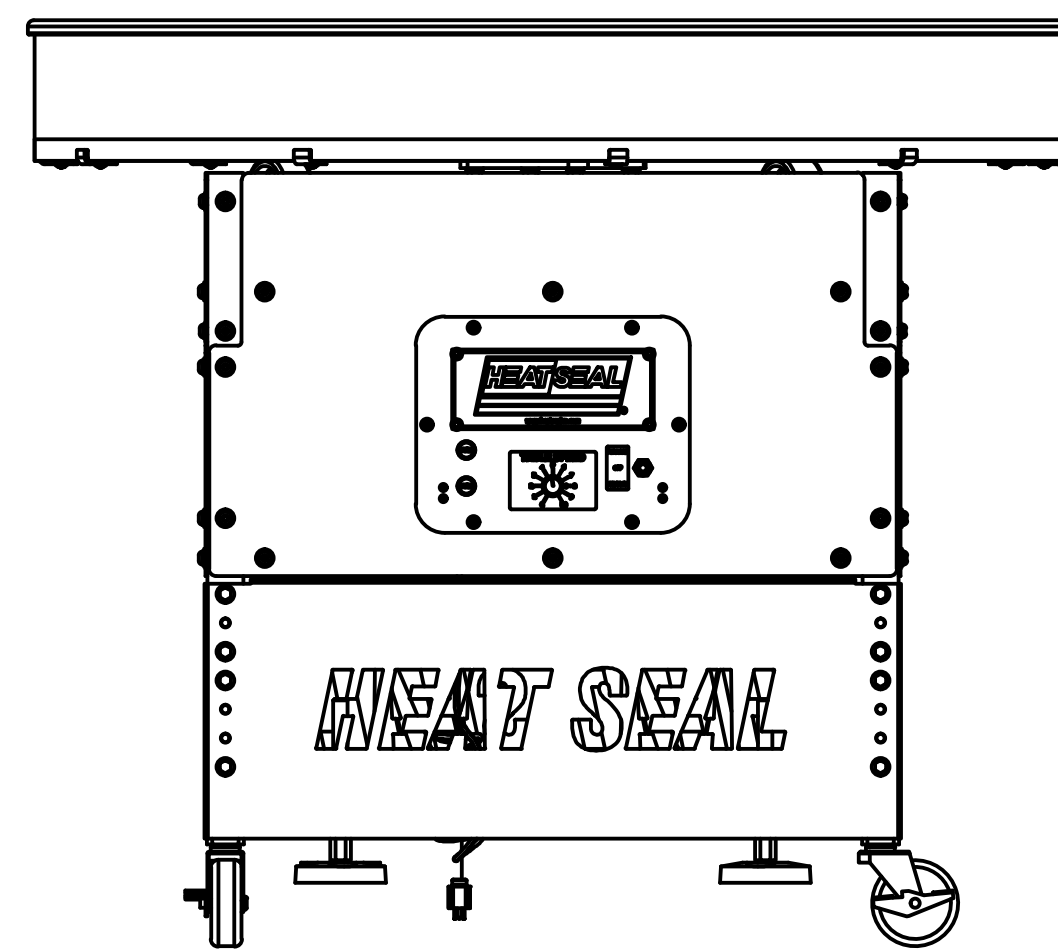
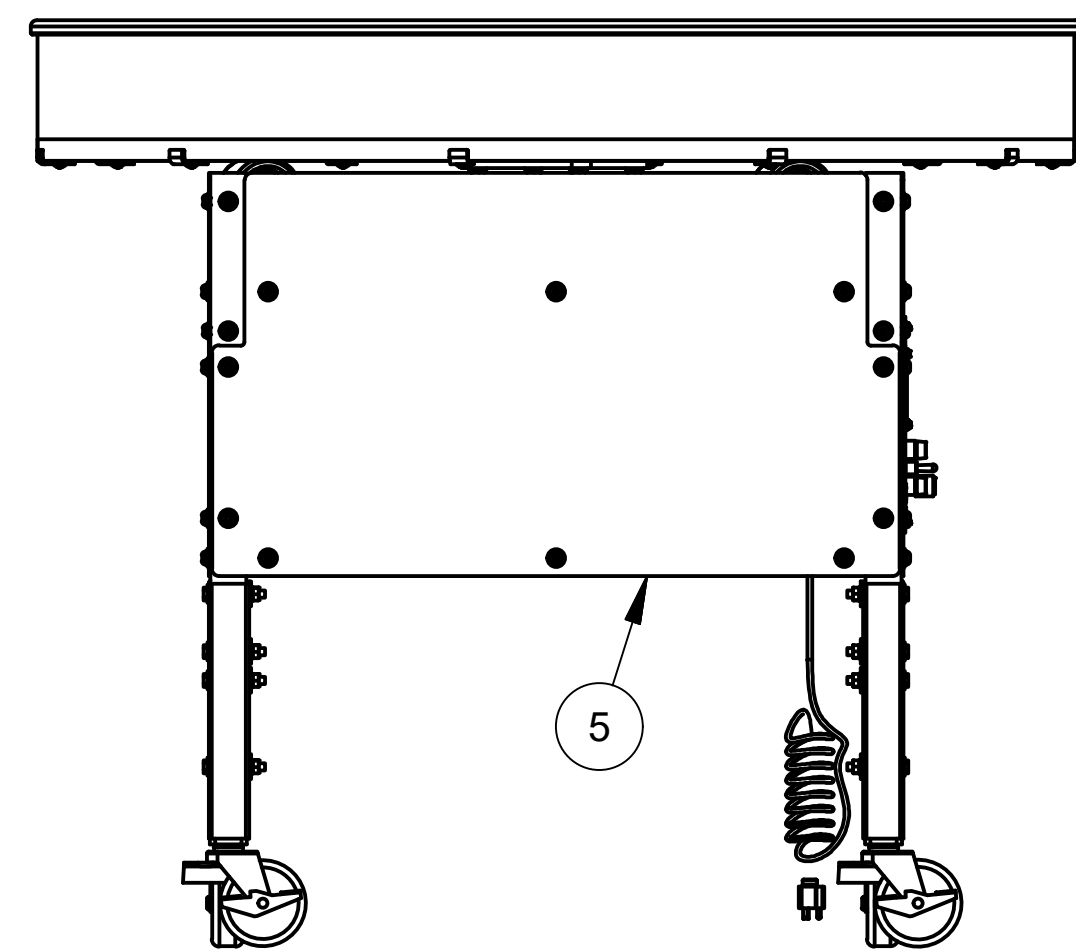

HEAT SEAL/AMPAK
CLEVELAND, OHIO 44125

CONFIDENTIAL
THIS PRINT IS PROPERTY OF, AND
DISCLOSES PROPRIETARY INFORMATION
OF HEAT SEAL. IT IS LOANED FOR
REFERENCE ONLY, AND MAY NOT BE
REPRODUCED OR FORWARDED
ELECTRONICALLY IN ANY MANNER, OR ITS
CONTENTS DISCLOSED TO OTHERS,
WITHOUT THE EXPLICIT WRITTEN
PERMISSION OF OWNER AND MUST BE
DESTROYED UPON REQUEST.

DESCRIPTION:
**ACCUMULATING POWER
TABLE, 36", 4" RIM, 115V**

DRAWING NUMBER:
AT-361R4XA

REVISION:
0

SIZE: D SCALE: NONE SHEET: 4 OF: 5

8 7 6 5 4 3 2 1

D

D

36.5

30
CAN BE RAISED
UP TO 6" MAX

32
CAN BE RAISED
IN 1" INCREMENTS,
3" MAX

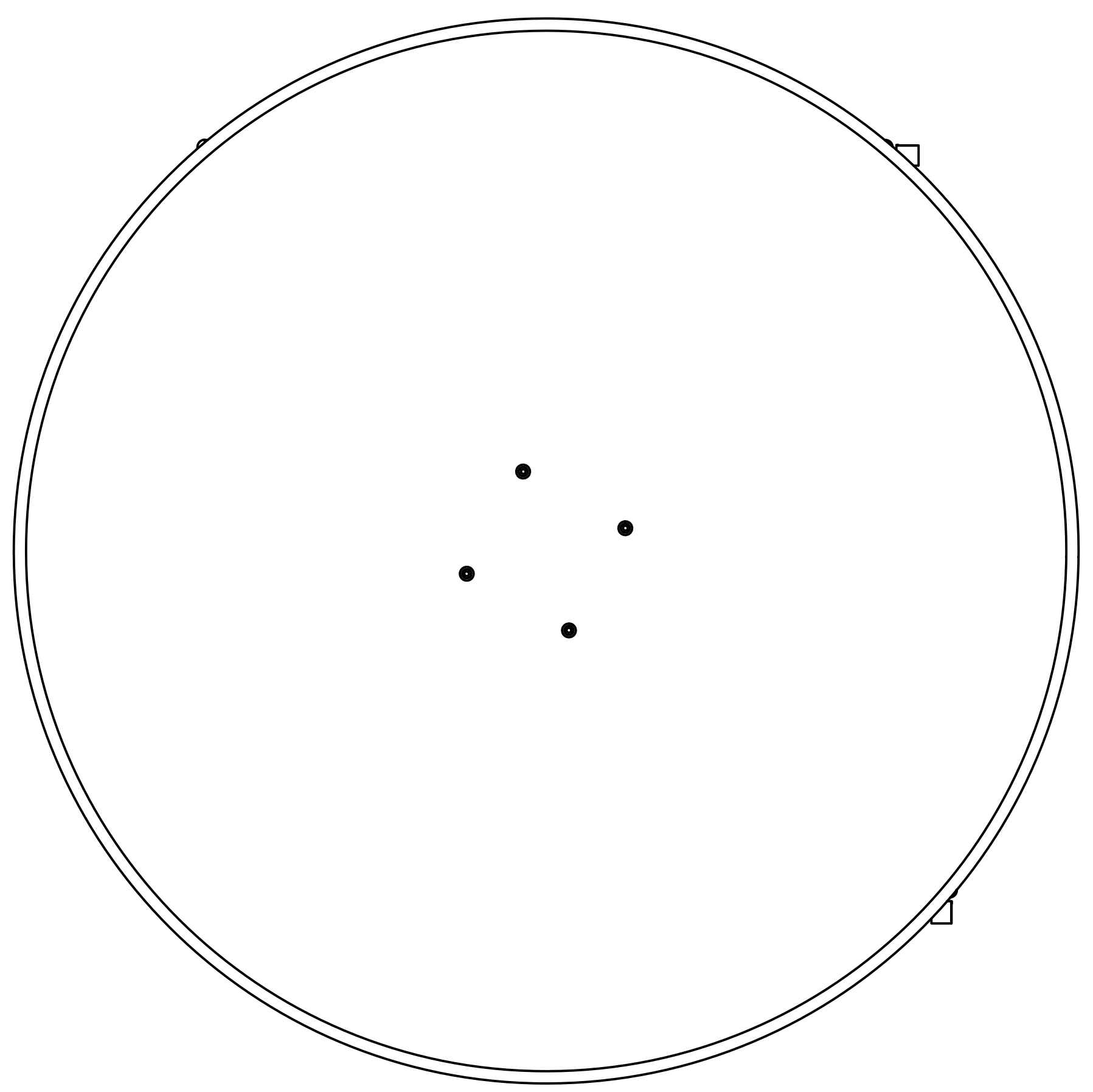
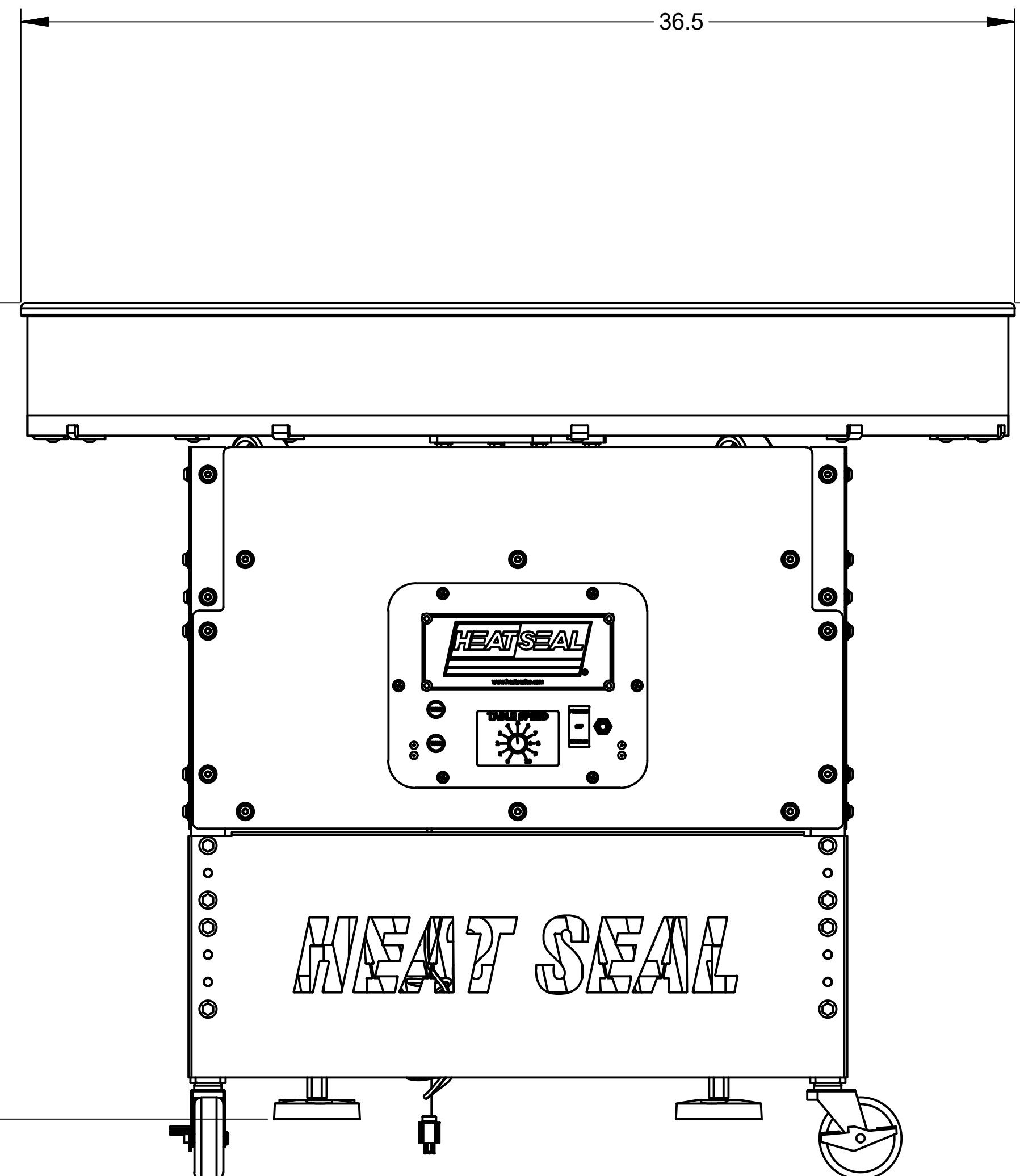

C

C

B

B

A

A

ELECTRICAL: 110-120VAC, 5A

HEAT SEAL/AMPAK
CLEVELAND, OHIO 44125

CONFIDENTIAL
THIS PRINT IS PROPERTY OF, AND
DISCLOSES PROPRIETARY INFORMATION
OF HEAT SEAL. IT IS LOANED FOR
REFERENCE ONLY, AND MAY NOT BE
REPRODUCED OR FORWARDED
ELECTRONICALLY IN ANY MANNER, OR ITS
CONTENTS DISCLOSED TO OTHERS,
WITHOUT THE EXPLICIT WRITTEN
PERMISSION OF OWNER AND MUST BE
DESTROYED UPON REQUEST.

DESCRIPTION:
**ACCUMULATING POWER
TABLE, 36", 4" RIM, 115V**

DRAWING NUMBER: AT-361R4XA	REVISION: 0
--------------------------------------	-----------------------

SIZE: D	SCALE: NONE	SHEET: 5	OF: 5
---------	-------------	----------	-------

8 7 6 5 4 3 2 1