

ITEM	QTY	PART NUMBER	DESCRIPTION
42	20	1909-008	WASHER, FENDER, SS, .875 OD X .25 ID X .075 THK
41	12.5FT	0910-018	U CHANNEL, EDGE MOLDING, BLACK
40	6	1911-021	NUT, HEX, NYLOCK 1/4-20, SS
39	32	1911-010	NUT, HEX, 1/4-20 SS
38	4	1911-004	NUT, HEX, FINISHED, 3/8-16 SS
37	10	1909-039	WASHER, FLAT, #8, SS
36	8	1909-009	WASHER, FLAT, 3/8, .406 ID X .812 OD X .065
35	112	1909-002	WASHER, FLAT, SS, 5/8 OD X 1/4 ID X .065 THK
34	10	1907-012	LOCKWASHER, SPLIT, #8 MED, SS
33	4	1907-009	LOCKWASHER, SPLIT, 3/8
32	108	1907-001	LOCKWASHER, SPLIT, 1/4 MED, SS
31	4	1903-731	SCR, CAP, HEX HD, SS, 3/8-16 X 2, PARTIAL THD
30	4	1903-633	SCR, FLAT HD, SS, SOCKET, 1/4-20 x 1.5 LG
29	4	1903-291	SCR, CAP, SOCKET HD, 1/4-28 X 3/4, SS
28	10	1903-275	SCR, MACH, PAN HD, PHIL, SS, #8-32 X 1/2 LG
27	16	1903-180	SCR, CAP, HEX HD, SS, 1/4-20 X 2 LG, W/ 3/4 THD
26	56	1903-169	SCR, CAP, BUTTON HD, SOCKET 1/4-20 X 5/8 LG, SS
25	34	1903-045	SCR, CAP, HEX HD, SS, 1/4-20 X 3/4 LG
24	2	1869-052	1/2 NPT LOCKNUT
23	2	1869-043	CORD GRIP, NYLON, 1/2 NPT, 0.18-.4 DIA
22	1	1863-001	SPEED CONTROL, CONVEYOR
21	1	1851-051	Power Cord 3-16, SJT, 84 IN. LG.
20	1	1839-071	GEARMOTOR, 90VDC, 42RPM, 166IN-LBS
19	1	2175-047	SPROCKET, ROLLER CHAIN #41, 41B11, 5/8 BORE, W/KW & SS
18	4	2135-041	LEVELER, SWIVEL, 1/2-13x5" STEM, 3.15" DIA FOOT
17	4	2125-015	CASTER, SWIVEL 3", POLYPROPYLENE, 270#
16	4	2115-022	INSERT, CASTER
15	4	2115-001	CASTER, SWIVEL, STEM TYPE, 3" W/BRAKE
14	2	2105-034	BEARING, FLG MT, SQ, 1" BORE, 2.75" HOLE SPCNG
13	8	6510-069	SHIM, 16GA, 2125015 CASTER
12	1	6510-247	ACCUMULATOR TABLE ASSY, 48", 4" RIM
11	1	6510-246	ELECTRICAL COVER PANEL ASSY, AT, 115V
10	1	6510-245	WIRING DIAGRAM, ACCUMULATOR TABLE
9	1	6510-244	DRIVE CHAIN ASSY, AT
8	3	6510-243	SIDE PANEL, AT
7	1	6510-242	DRIVE MOUNT PLATE, AT
6	2	6510-241	CASTER MOUNT PLATE, AT
5	2	6510-240	LEG JOINING PLATE, AT
4	1	6510-237	ELECTRICAL PANEL WELDMENT, AT
3	1	6510-236	DRIVE SHAFT WELDMENT, AT
2	2	6510-235	LEG WELDMENT, AT
1	1	6510-234	FRAME WELDMENT, ACCUMULATOR PWR TBL

Material Specification

HEAT SEAL/AMPAK
CLEVELAND, OHIO 44125

<p>CONFIDENTIAL THIS PRINT IS PROPERTY OF, AND DISCLOSES PROPRIETARY INFORMATION OF HEAT SEAL. IT IS LOANED FOR REFERENCE ONLY, AND MAY NOT BE REPRODUCED OR FORWARDED ELECTRONICALLY IN ANY MANNER, OR ITS CONTENTS DISCLOSED TO OTHERS, WITHOUT THE EXPLICIT WRITTEN PERMISSION OF OWNER AND MUST BE DESTROYED UPON REQUEST.</p>	UNLESS OTHERWISE SPECIFIED:	CREATED: 9/9/2020	<p>DESCRIPTION: ACCUMULATING POWER TABLE, 48", 4" RIM, 115V</p>	
	ALL DIMENSIONS IN INCHES	CREATED BY: MABBOTT		
	STANDARD TOLERANCES:	CHECKED:	DRAWING NUMBER: AT-481R4XA	REVISION: 0
	0.00: ± .010 0.000: ± .005 ANGLE: ± 1'	CHECKED BY:	SIZE: D SCALE: NONE SHEET: 1 OF: 5	

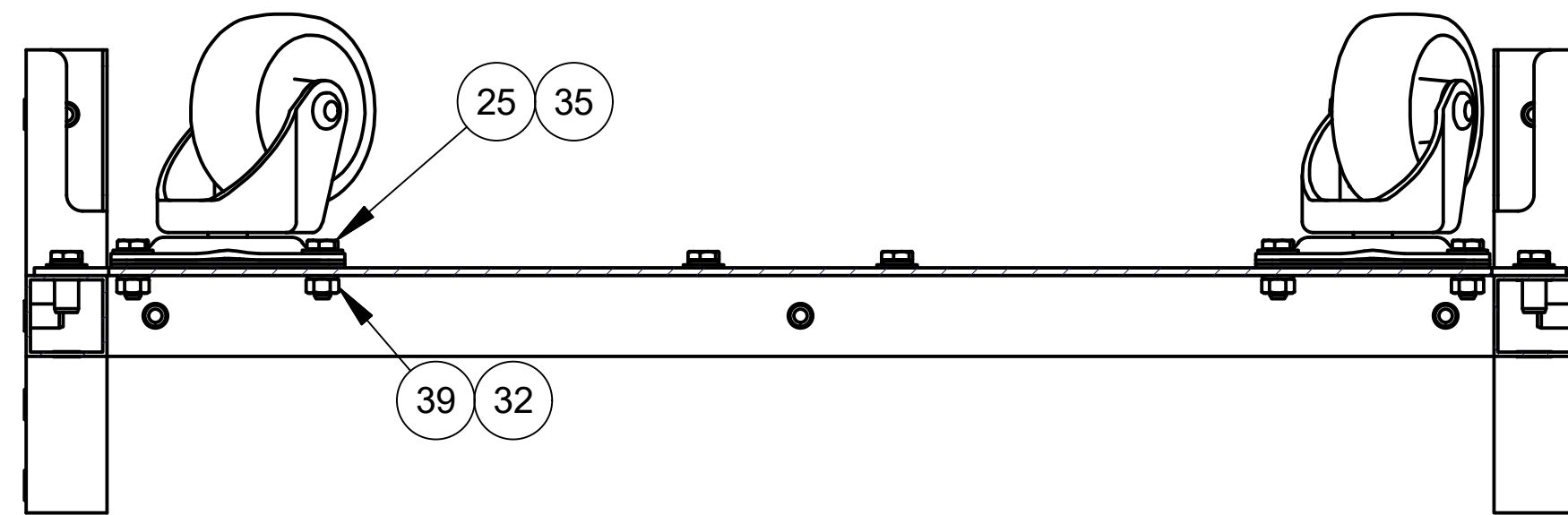
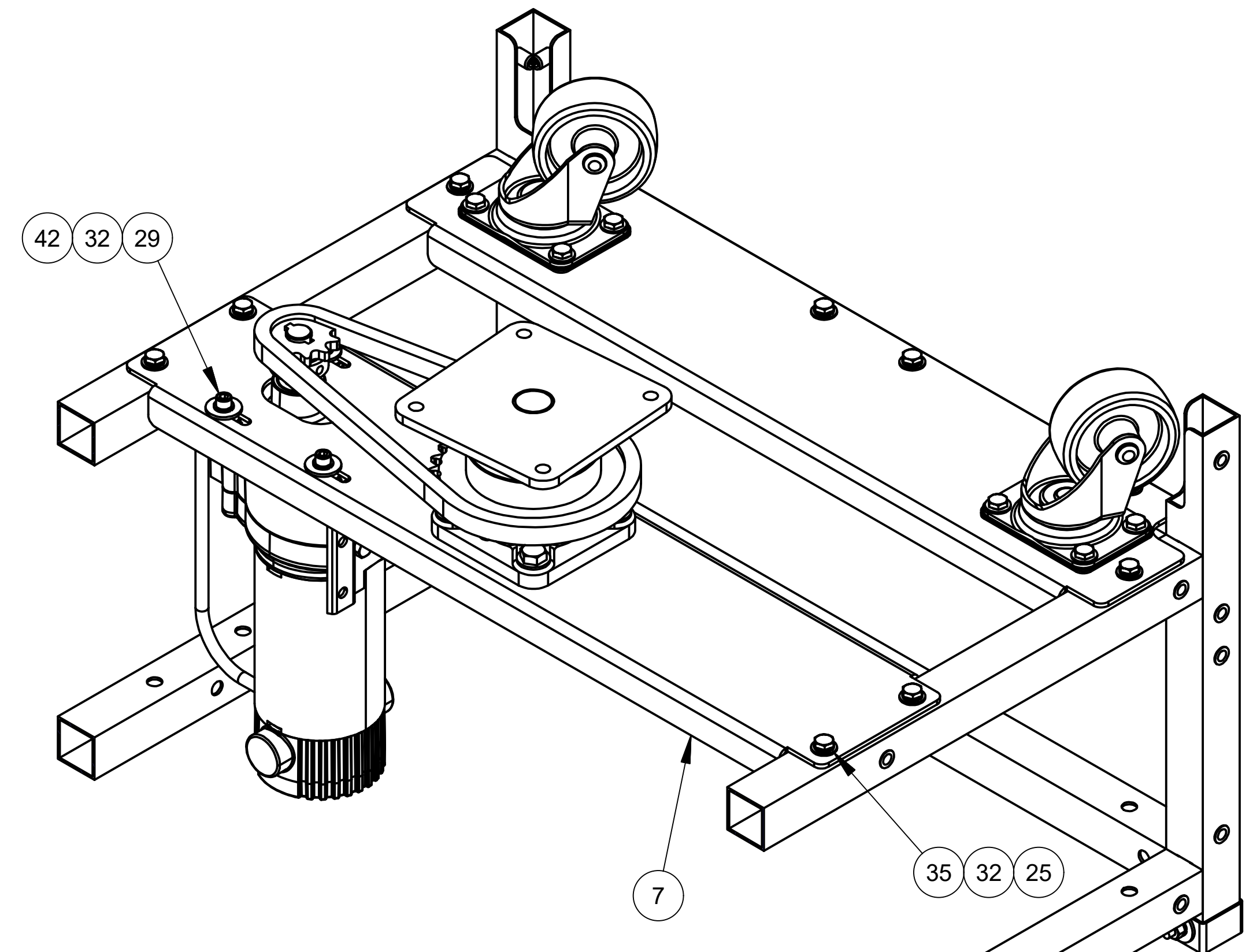
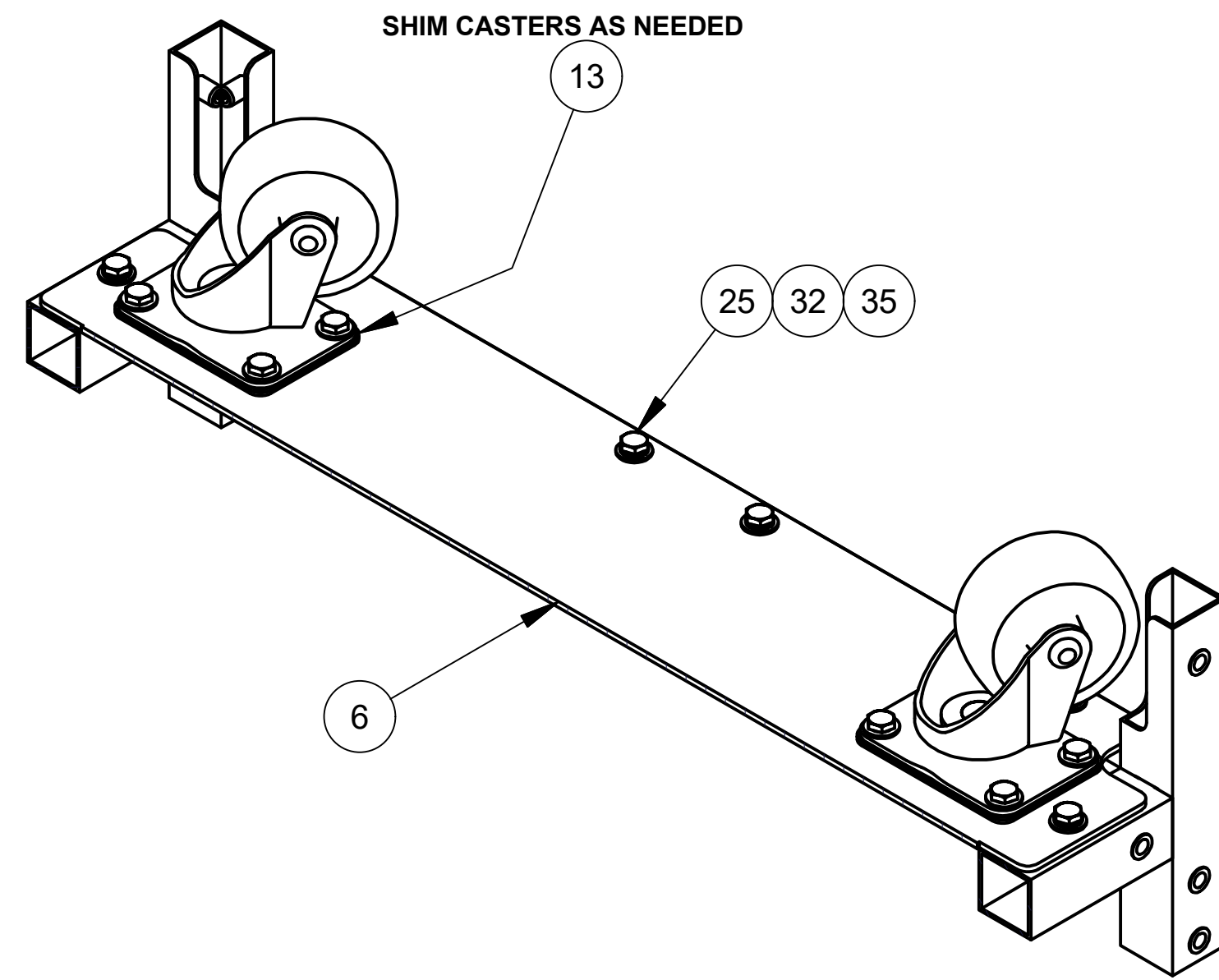
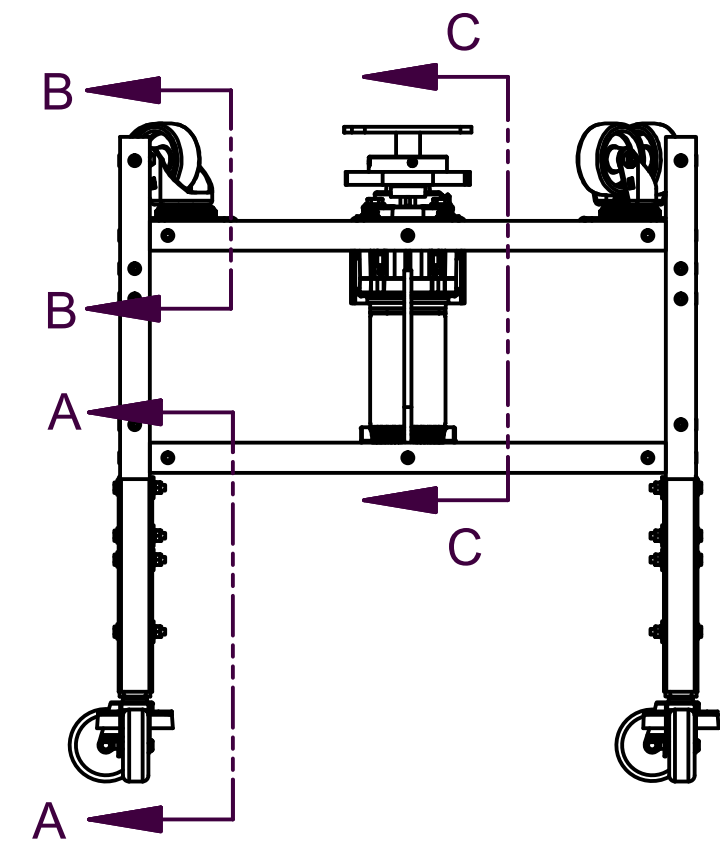
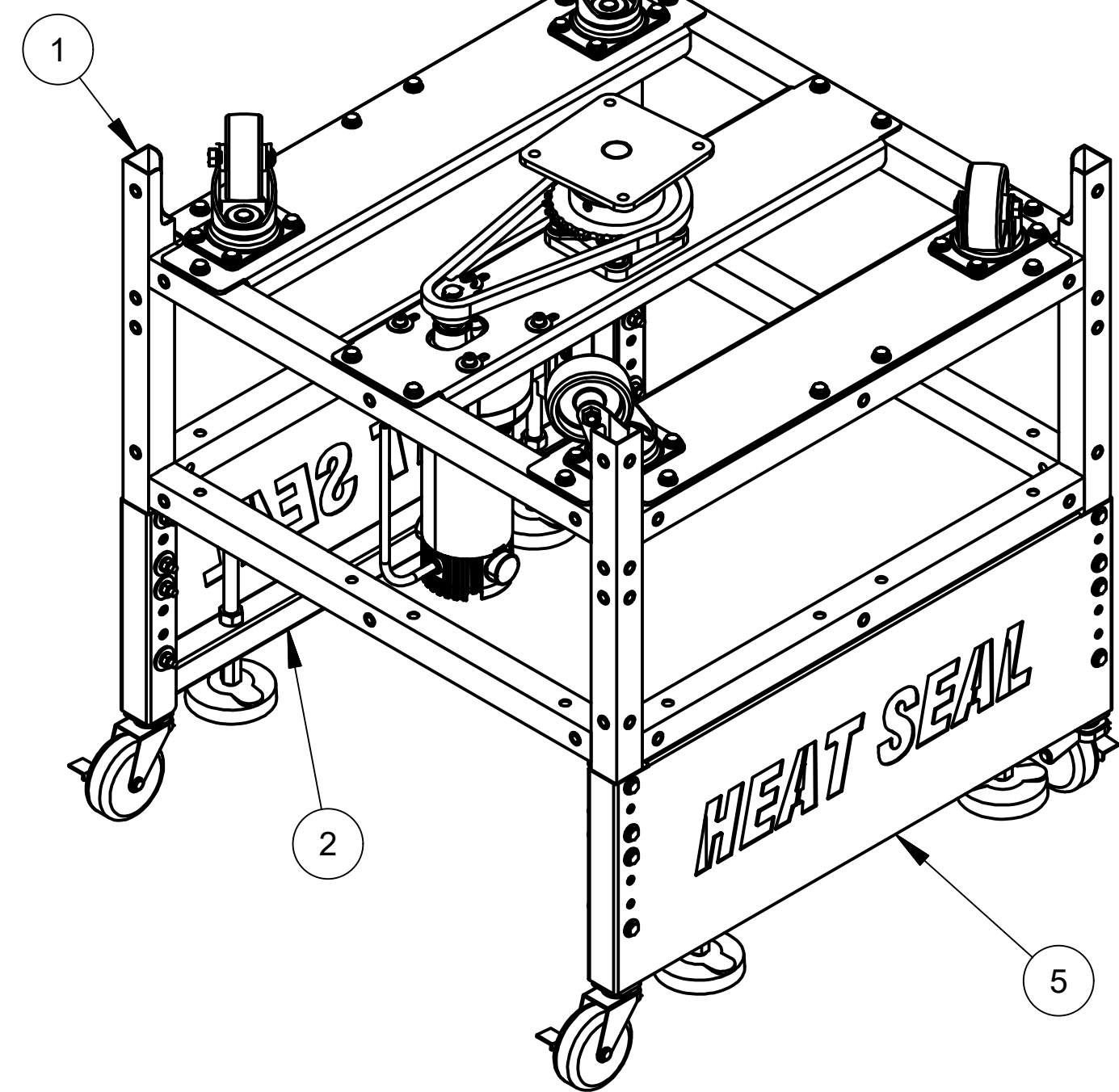

SECTION B-B

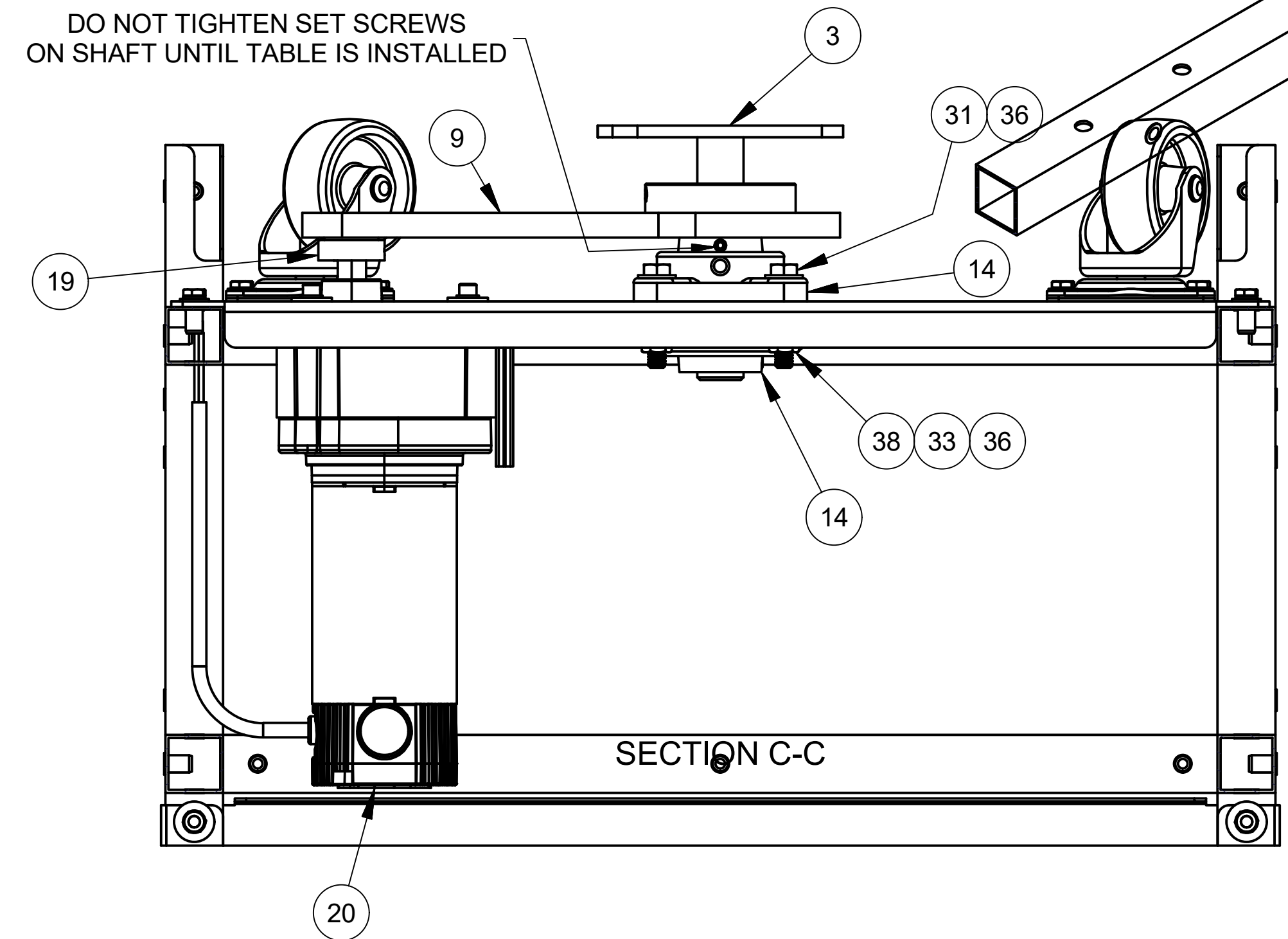

SECTION C-C

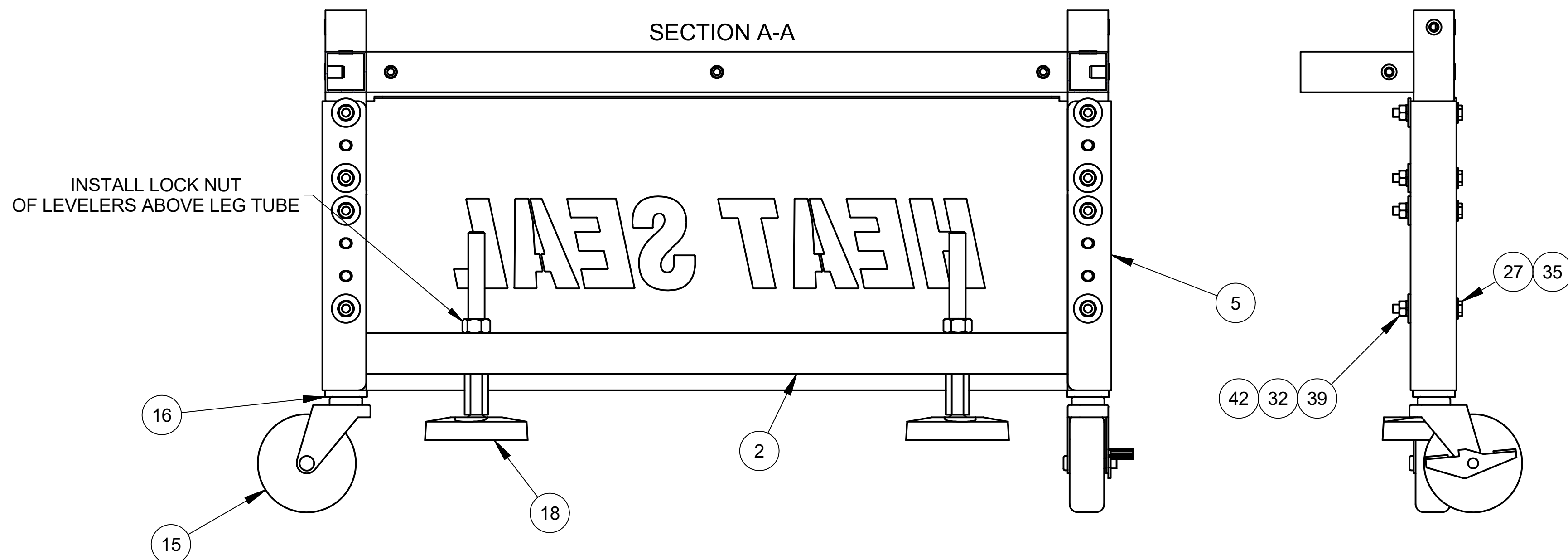

SECTION A-A

HEAT SEAL/AMPAK
CLEVELAND, OHIO 44125

CONFIDENTIAL
THIS PRINT IS PROPERTY OF, AND DISCLOSES PROPRIETARY INFORMATION OF HEAT SEAL. IT IS LOANED FOR REFERENCE ONLY, AND MAY NOT BE REPRODUCED OR FORWARDED ELECTRONICALLY IN ANY MANNER, OR ITS CONTENTS DISCLOSED TO OTHERS, WITHOUT THE EXPLICIT WRITTEN PERMISSION OF OWNER AND MUST BE DESTROYED UPON REQUEST.

DESCRIPTION:
ACCUMULATING POWER TABLE, 48", 4" RIM, 115V

DRAWING NUMBER:
AT-481R4XA

REVISION:
0

SIZE: D SCALE: NONE SHEET: 2 OF: 5

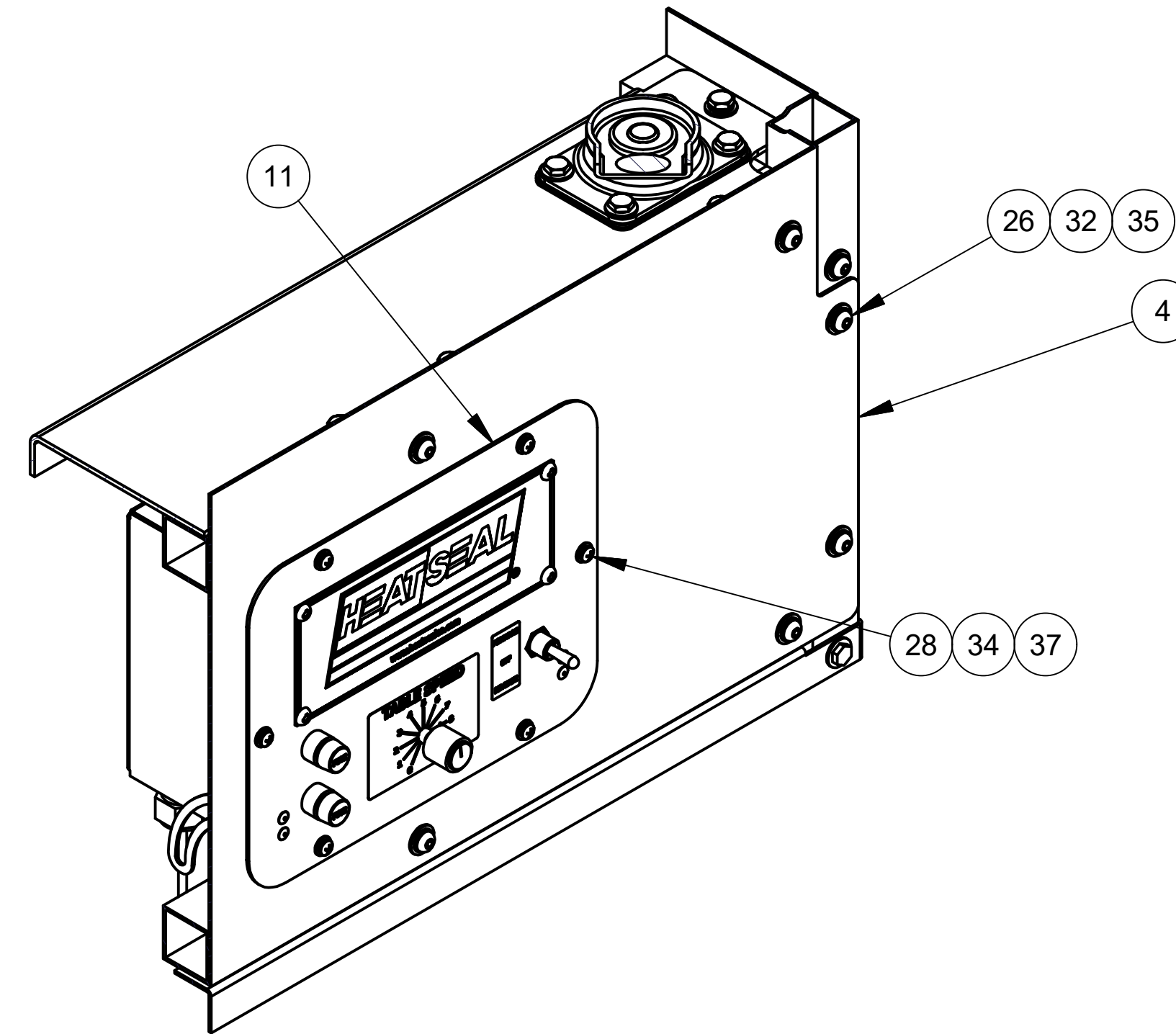
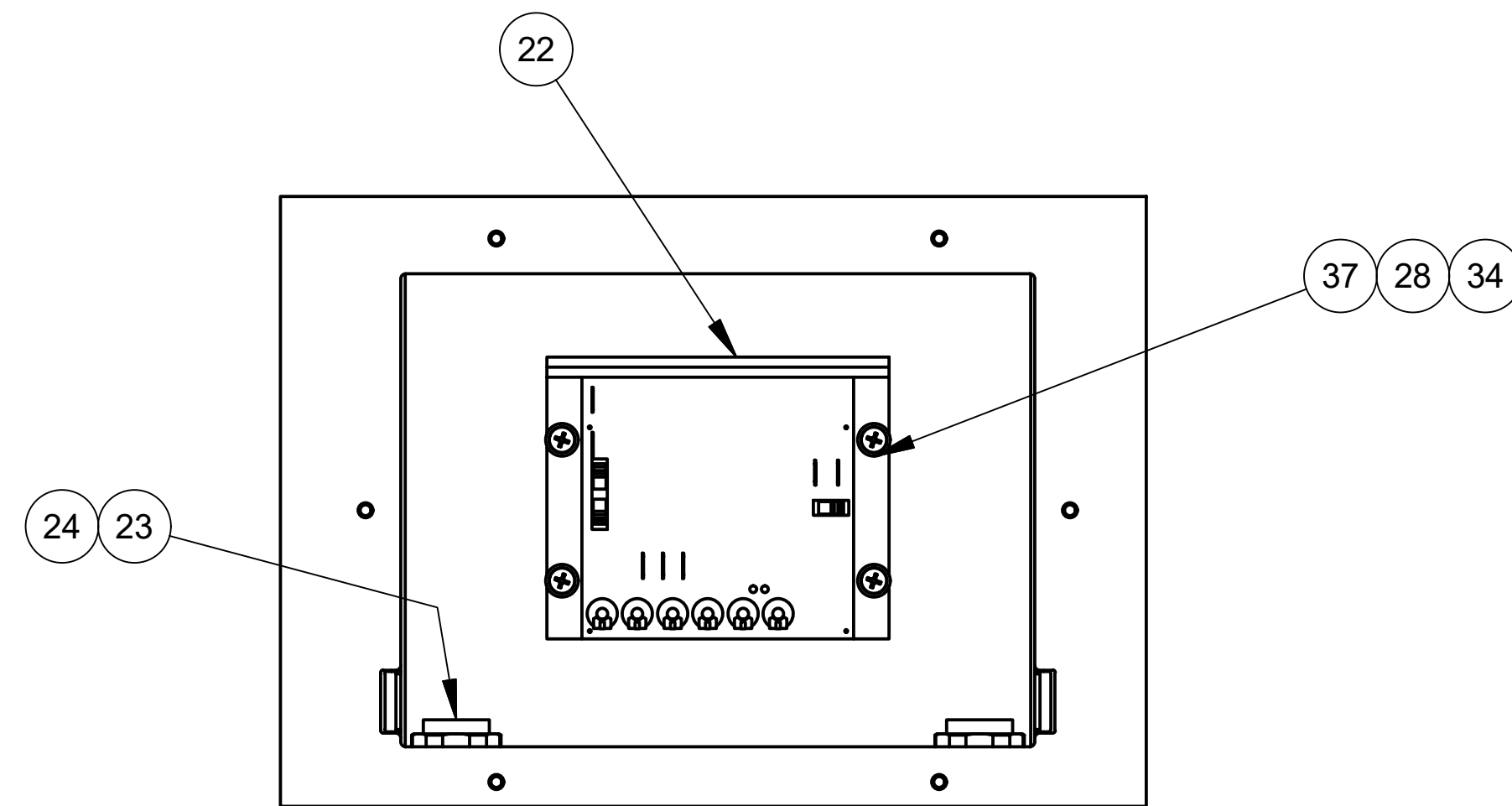
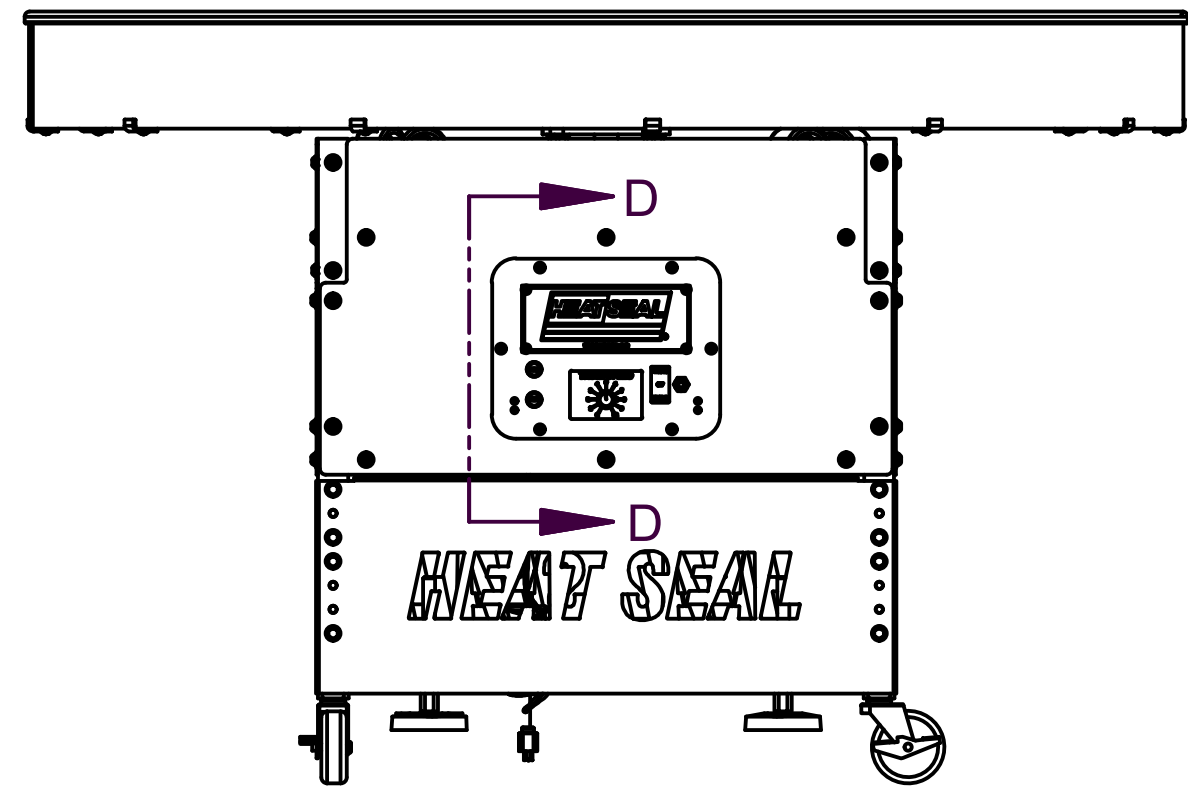

TYP ALL UNUSED RIVNUTS

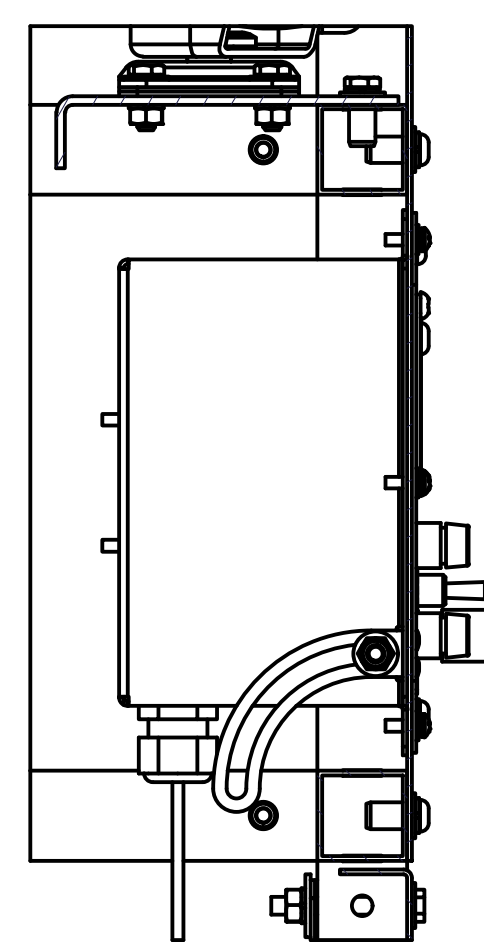
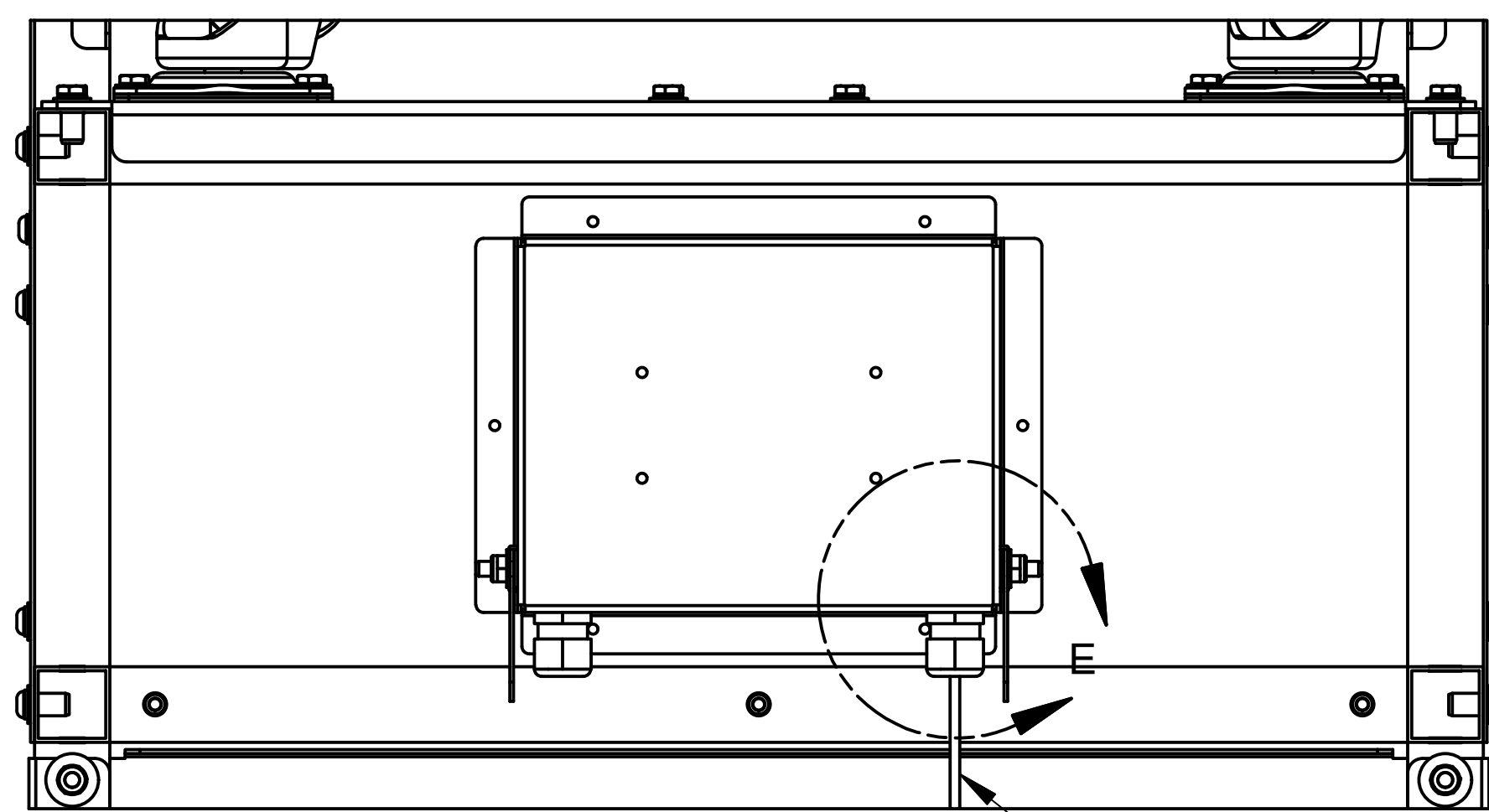
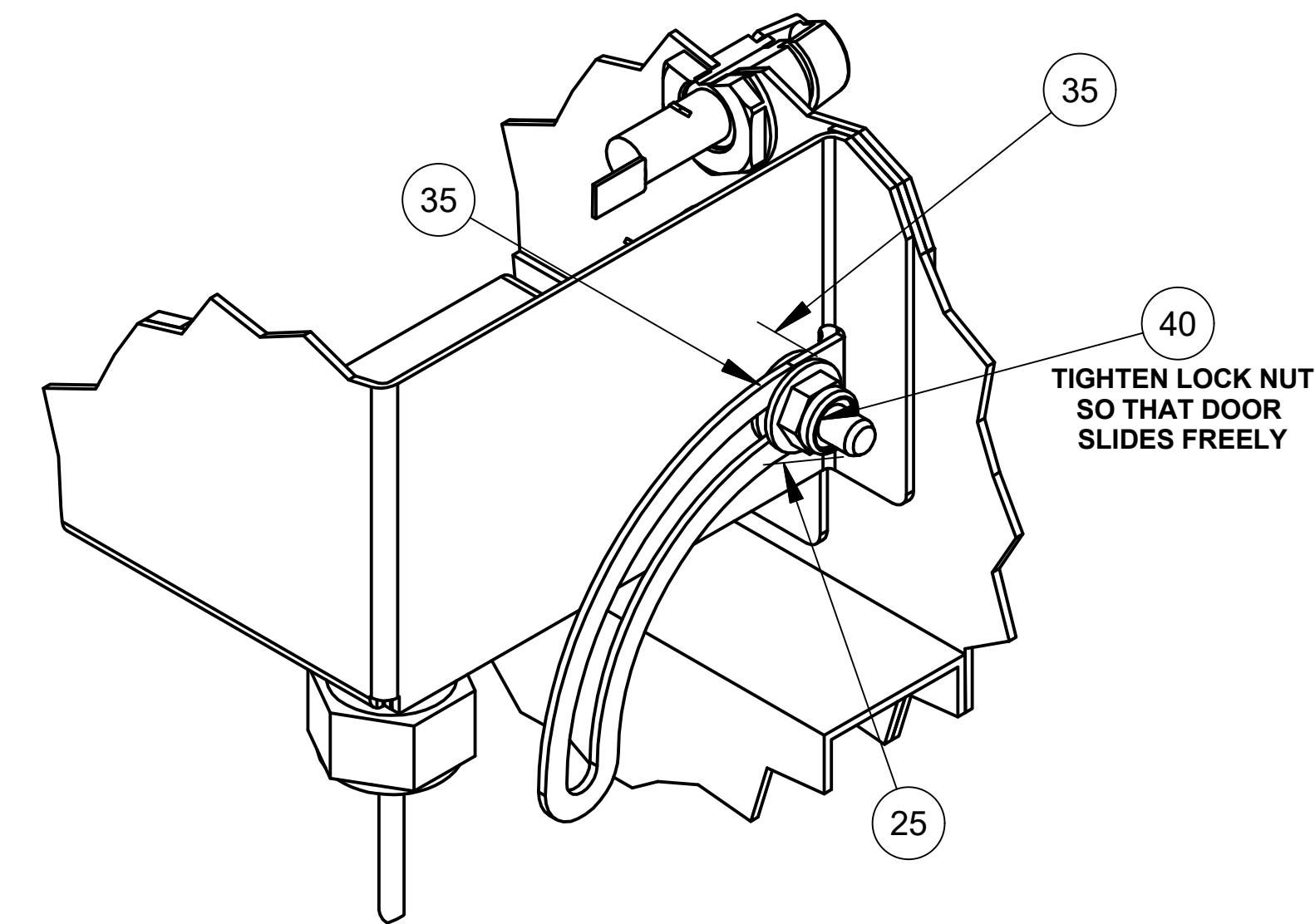

SECTION D-D

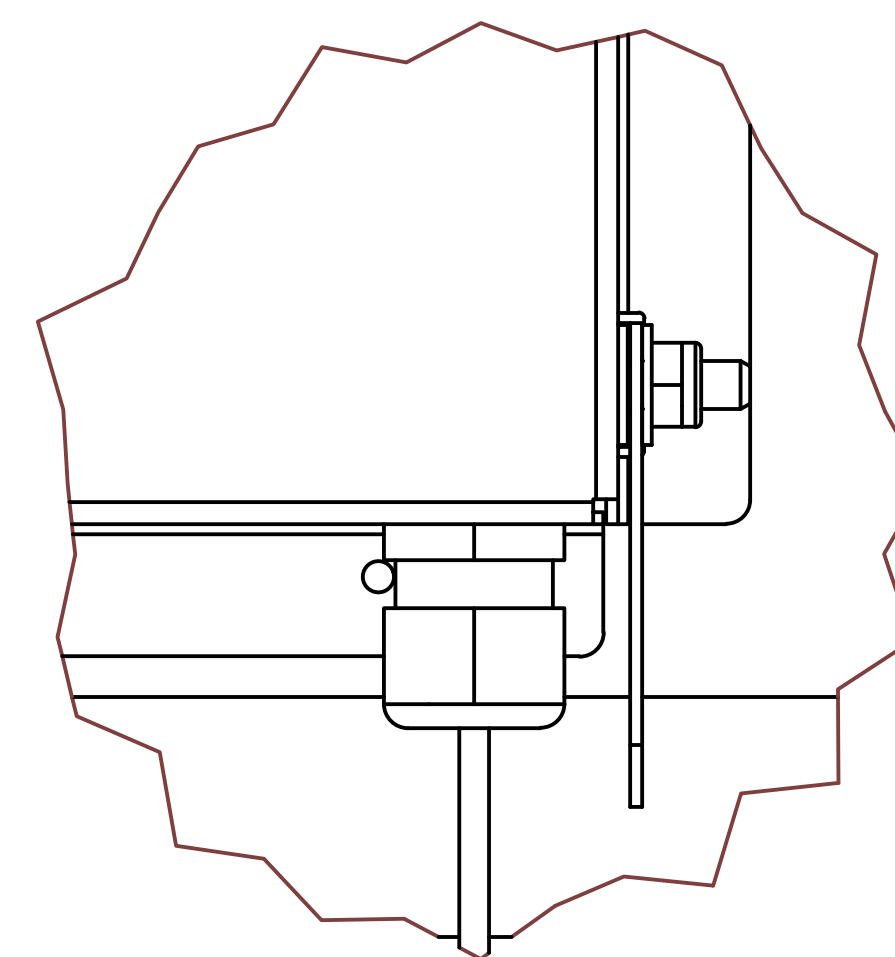

DETAIL E

HEAT SEAL/AMPAK
CLEVELAND, OHIO 44125

CONFIDENTIAL
THIS PRINT IS PROPERTY OF, AND DISCLOSES PROPRIETARY INFORMATION OF HEAT SEAL. IT IS LOANED FOR REFERENCE ONLY, AND MAY NOT BE REPRODUCED OR FORWARDED ELECTRONICALLY IN ANY MANNER, OR ITS CONTENTS DISCLOSED TO OTHERS, WITHOUT THE EXPLICIT WRITTEN PERMISSION OF OWNER AND MUST BE DESTROYED UPON REQUEST.

DESCRIPTION:
ACCUMULATING POWER TABLE, 48", 4" RIM, 115V

DRAWING NUMBER:
AT-481R4XA

REVISION:
0

SIZE: D SCALE: NONE SHEET: 3 OF: 5

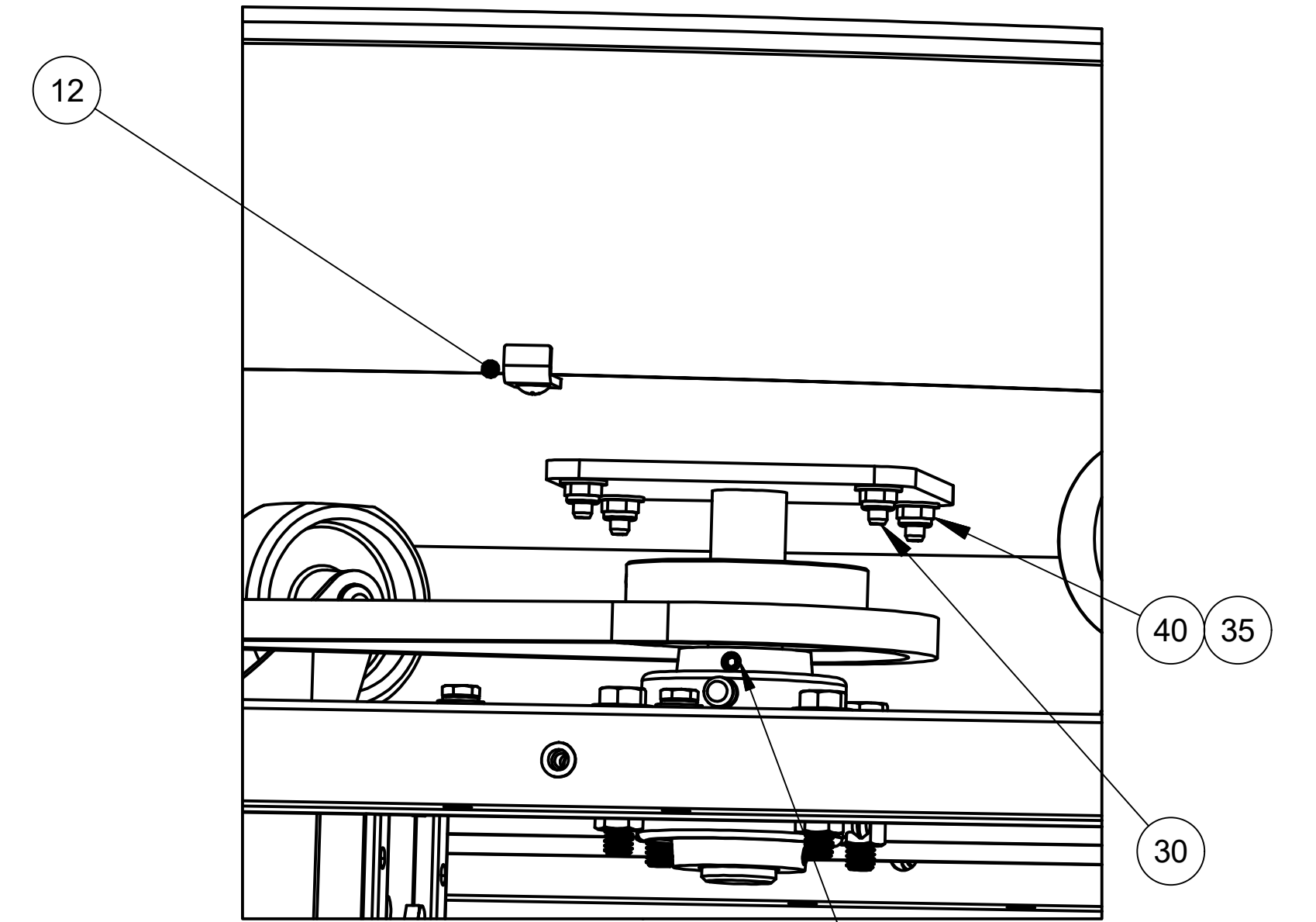
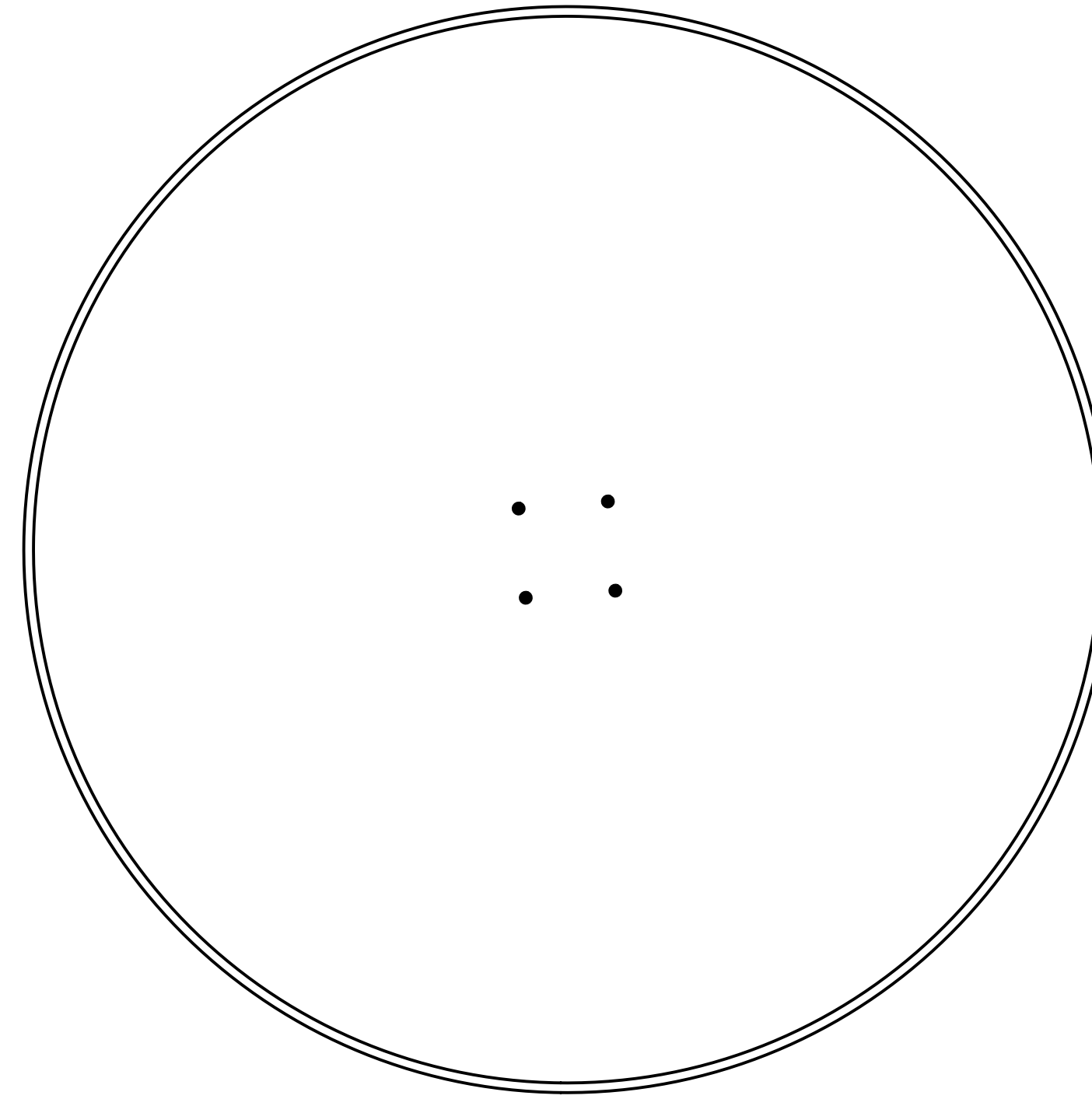
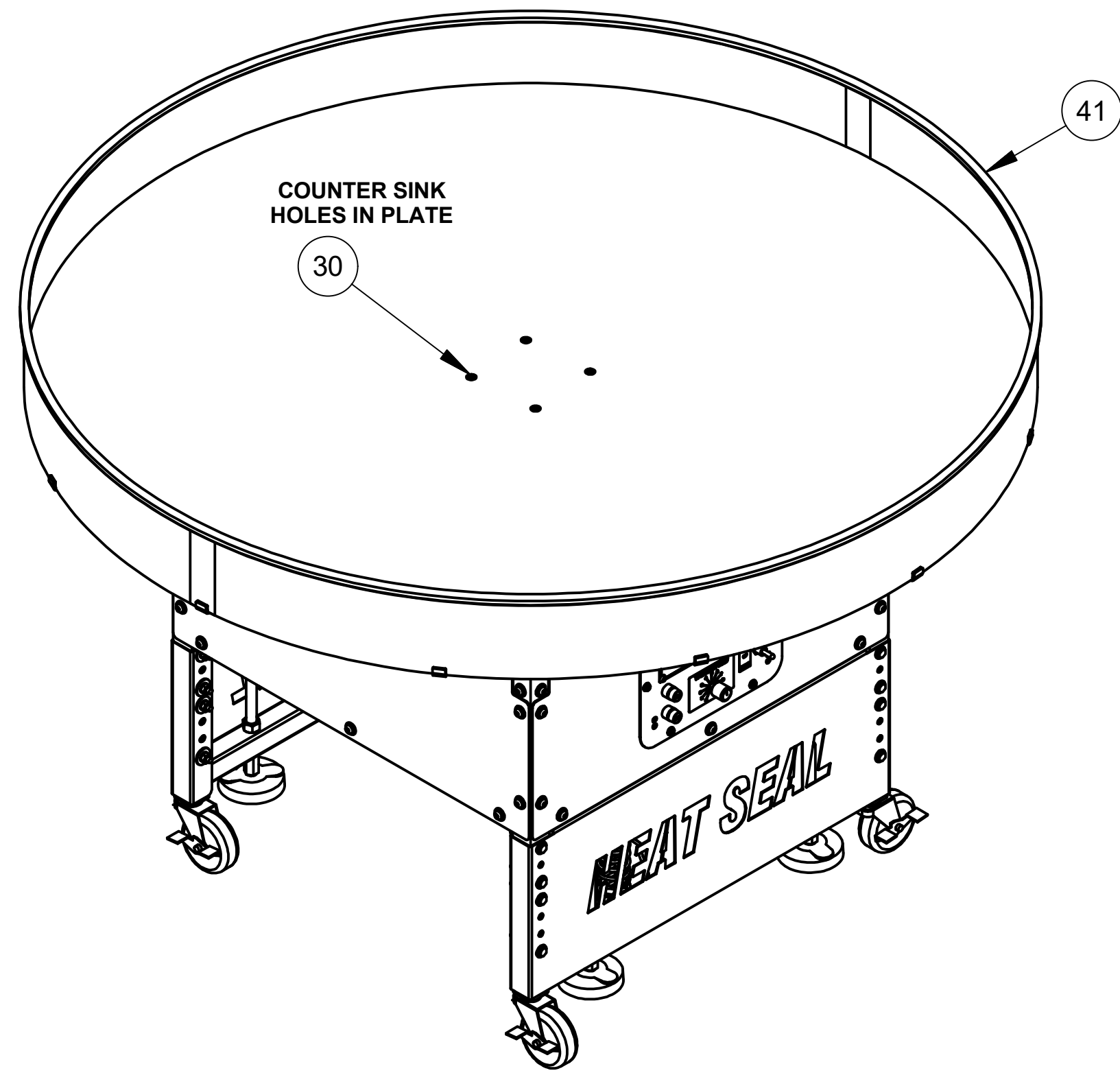

TIGHTEN SET SCREW WITH TABLE INSTALLED. MAKE SURE SPROCKETS ARE LEVEL WITH EACH OTHER.

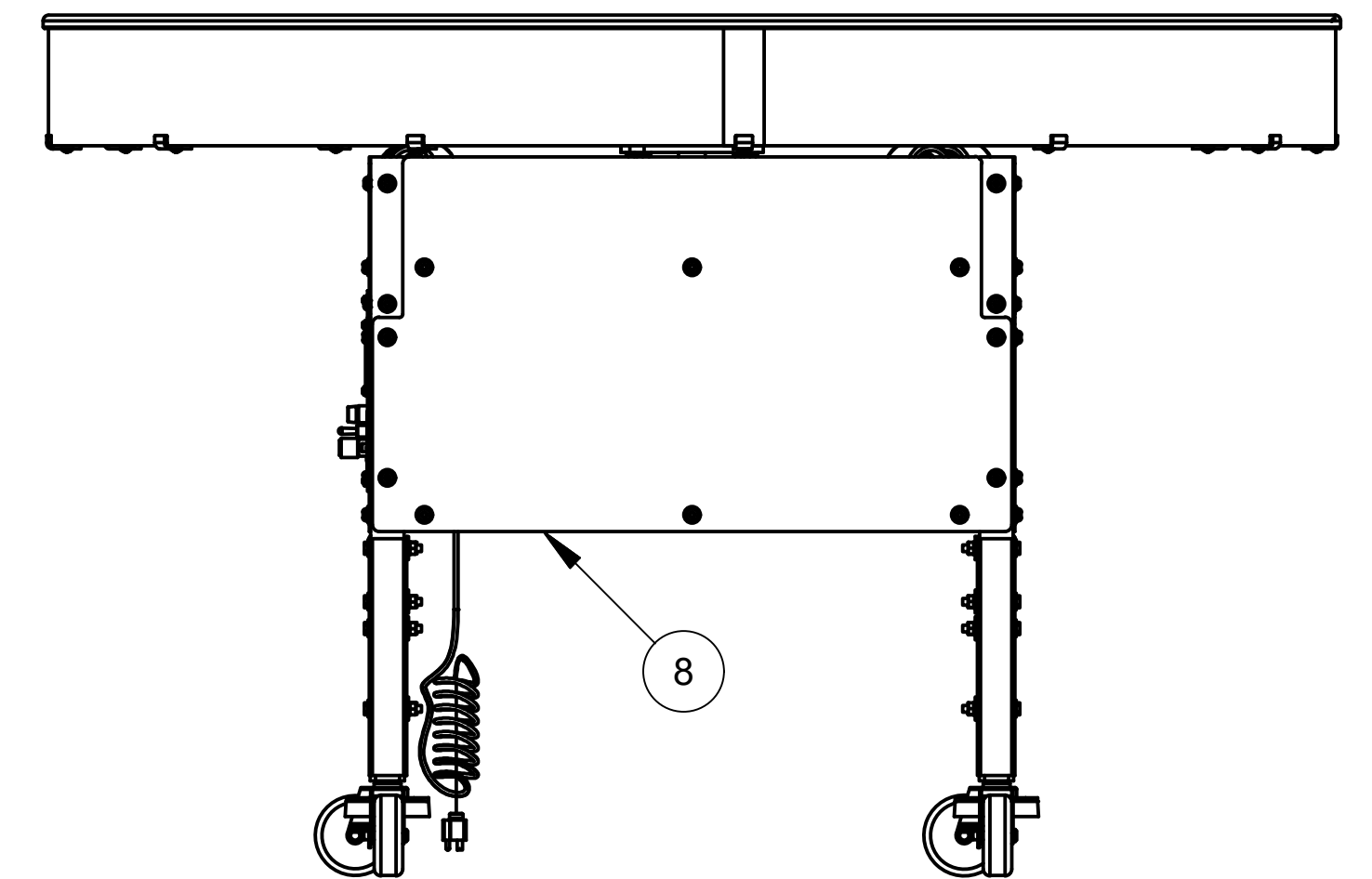
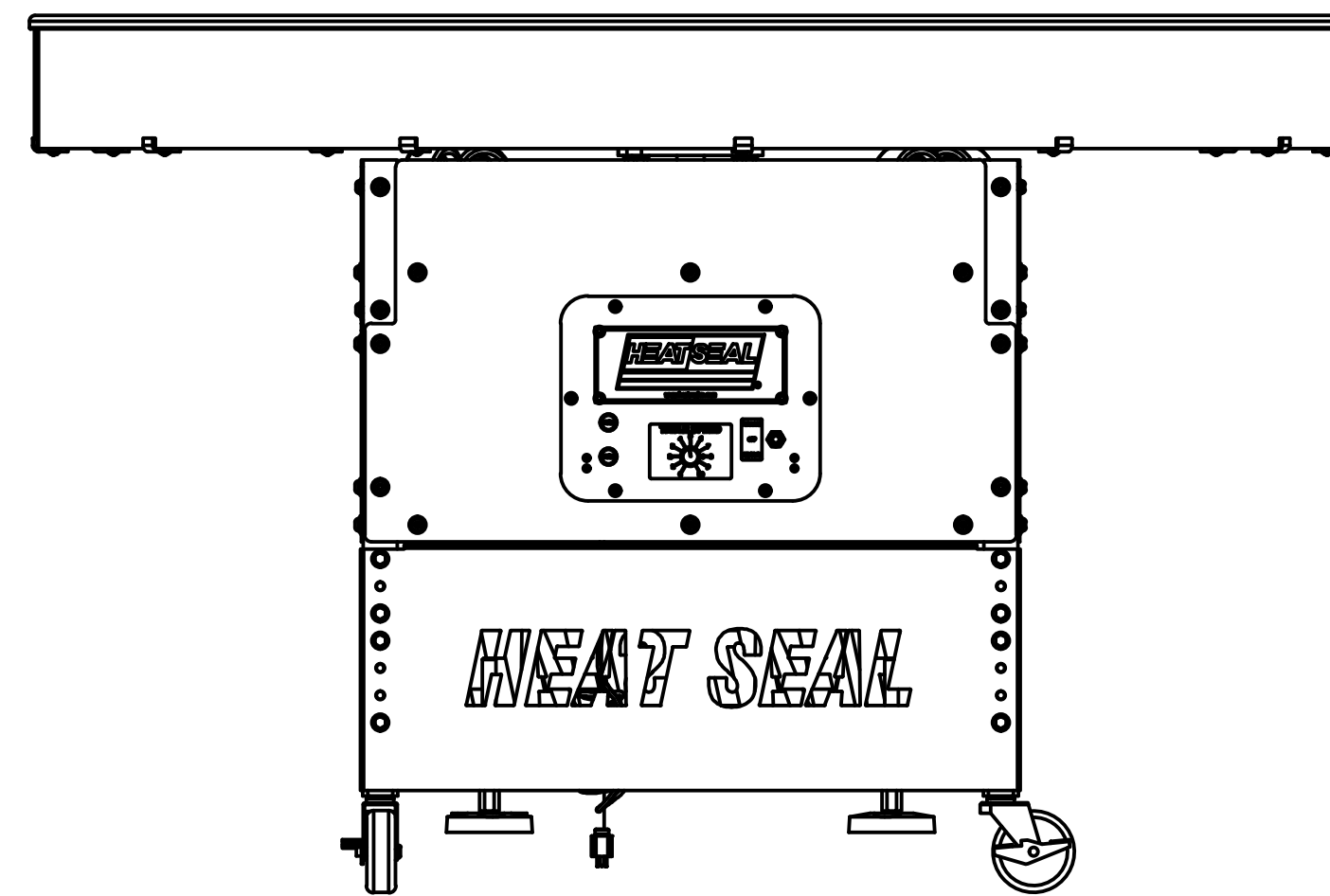
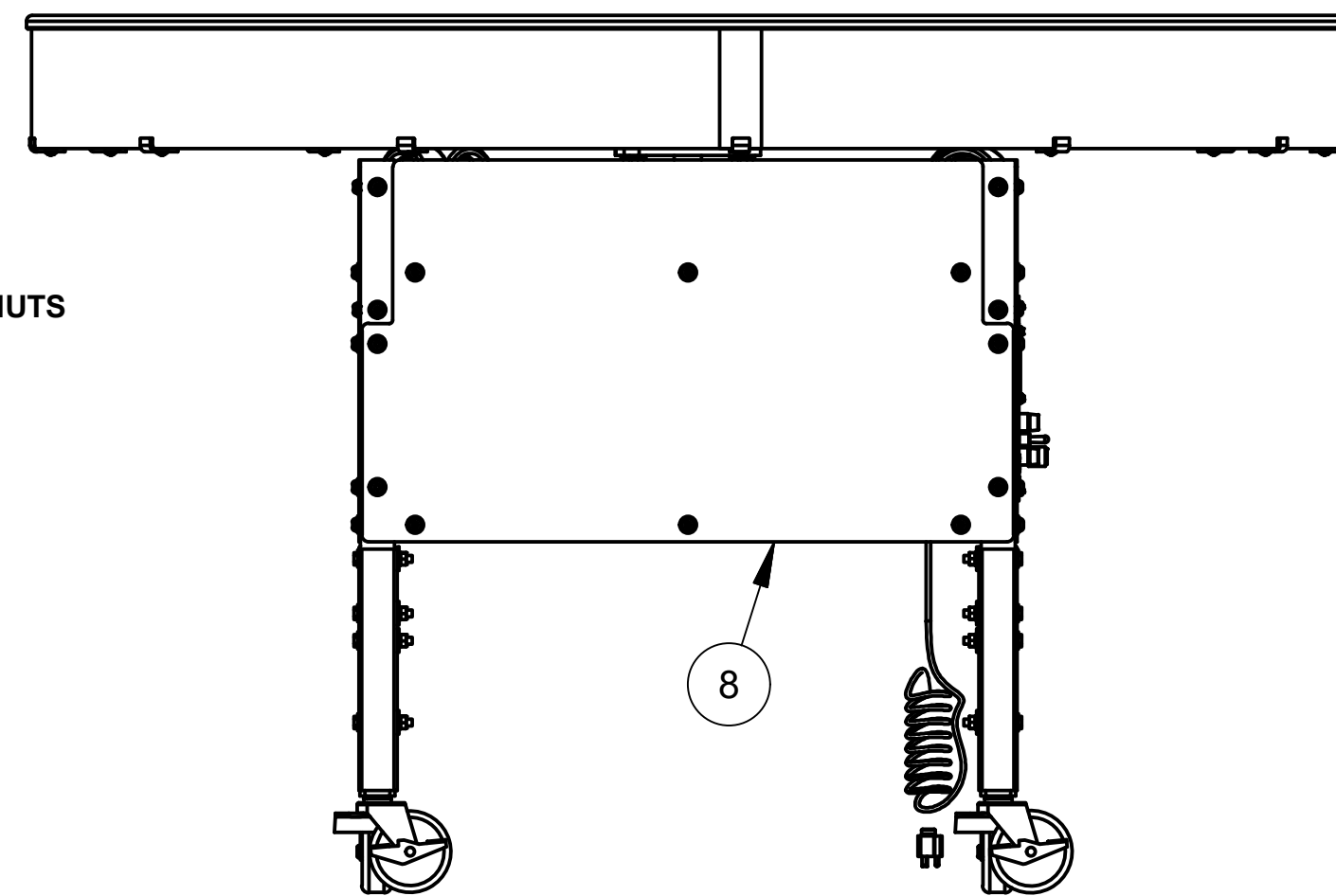
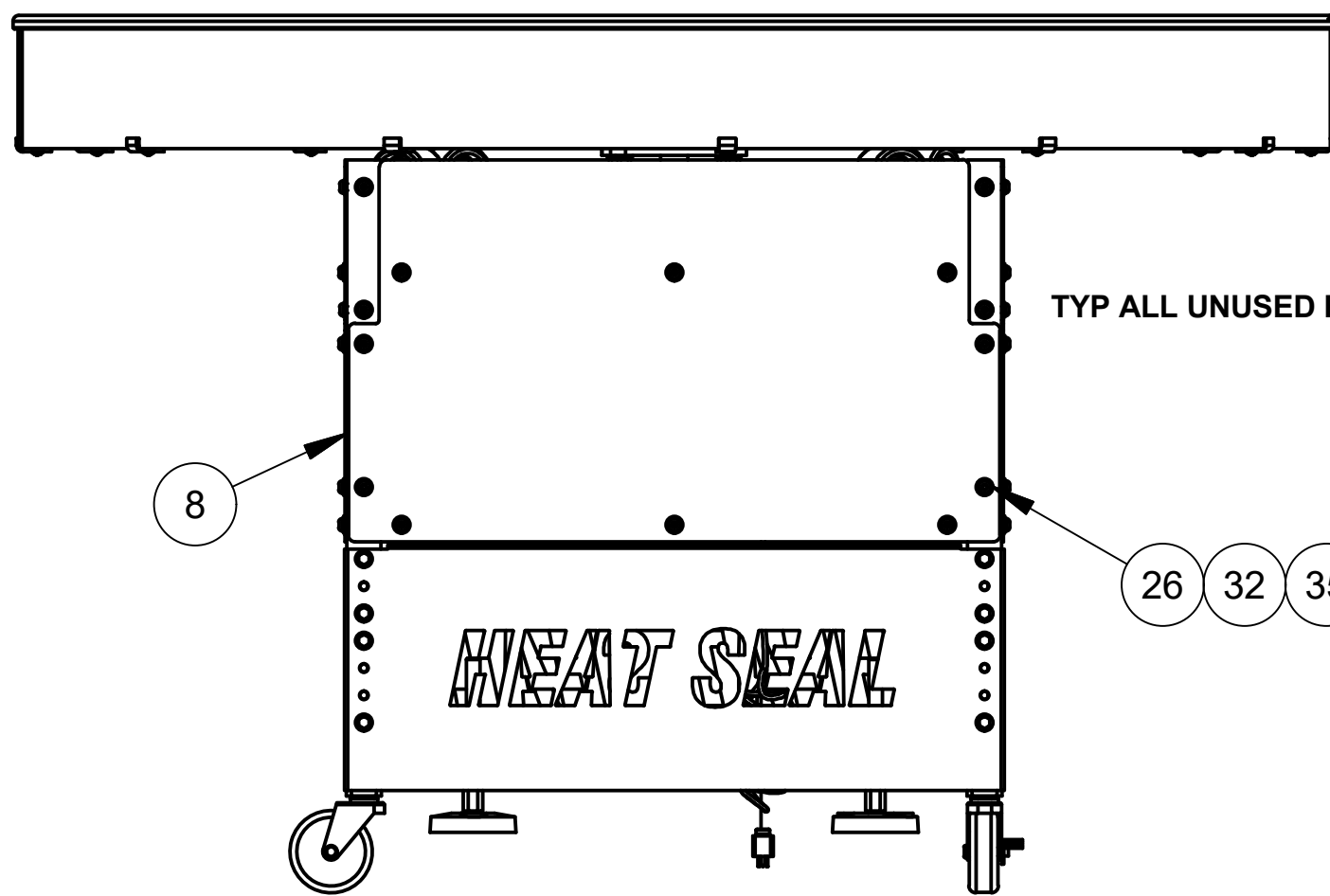

HEAT SEAL/AMPAK
CLEVELAND, OHIO 44125

CONFIDENTIAL
THIS PRINT IS PROPERTY OF, AND DISCLOSES PROPRIETARY INFORMATION OF HEAT SEAL. IT IS LOANED FOR REFERENCE ONLY, AND MAY NOT BE REPRODUCED OR FORWARDED ELECTRONICALLY IN ANY MANNER, OR ITS CONTENTS DISCLOSED TO OTHERS, WITHOUT THE EXPLICIT WRITTEN PERMISSION OF OWNER AND MUST BE DESTROYED UPON REQUEST.

DESCRIPTION:
ACCUMULATING POWER TABLE, 48", 4" RIM, 115V

DRAWING NUMBER:
AT-481R4XA

REVISION:
0

SIZE: D SCALE: NONE SHEET: 4 OF: 5

8 7 6 5 4 3 2 1

D

C

B

A

D

C

B

A

48.5

30
CAN BE RAISED
UP TO 6" MAX

32
CAN BE RAISED
IN 1" INCREMENTS,
3" MAX

HEAT SEAL

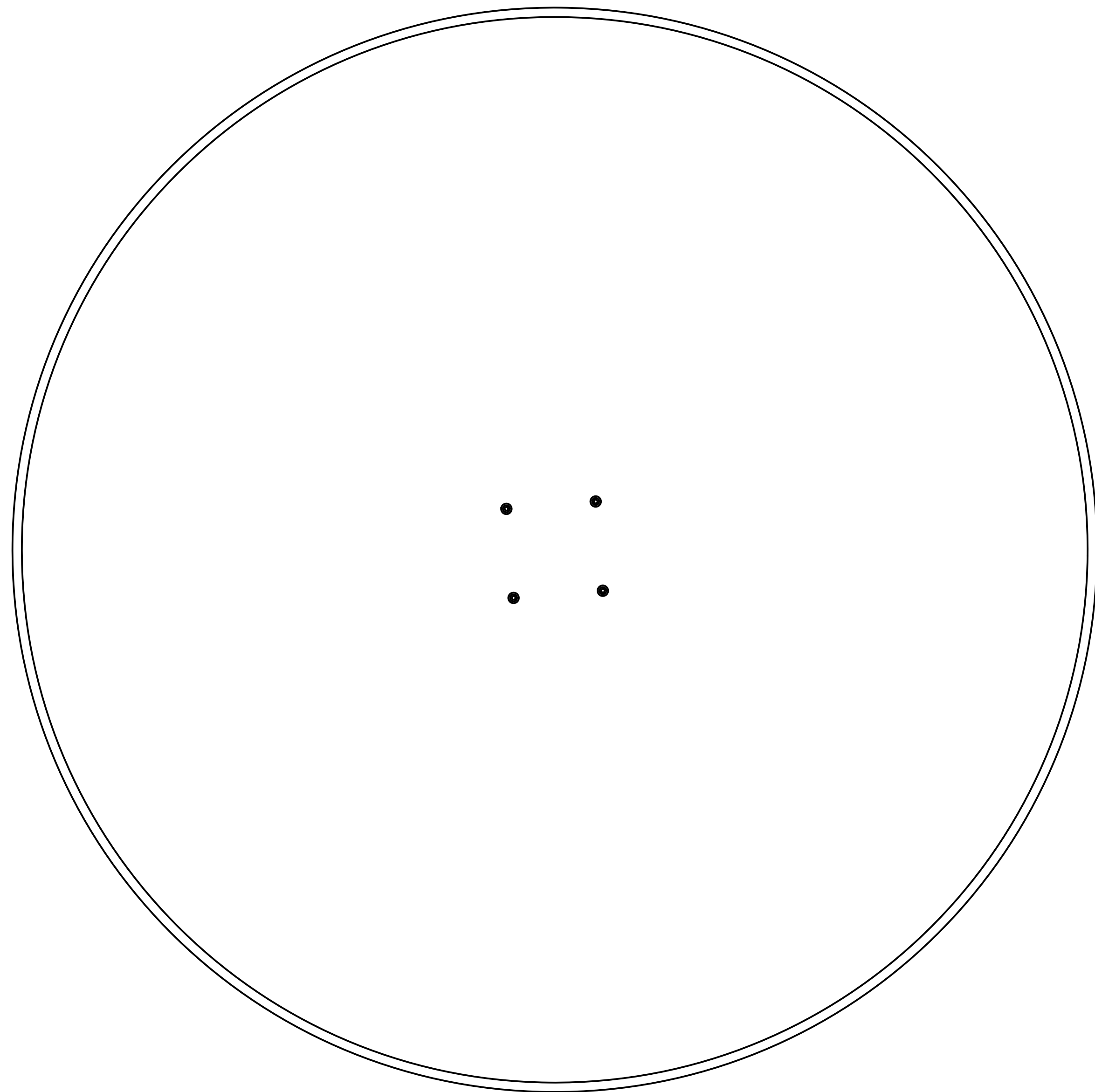

ELECTRICAL: 110-120VAC, 5A

8 7 6 5 4 3 2 1

HEAT SEAL/AMPAK
CLEVELAND, OHIO 44125

CONFIDENTIAL
THIS PRINT IS PROPERTY OF, AND
DISCLOSES PROPRIETARY INFORMATION
OF HEAT SEAL. IT IS LOANED FOR
REFERENCE ONLY, AND MAY NOT BE
REPRODUCED OR FORWARDED
ELECTRONICALLY IN ANY MANNER, OR ITS
CONTENTS DISCLOSED TO OTHERS,
WITHOUT THE EXPLICIT WRITTEN
PERMISSION OF OWNER AND MUST BE
DESTROYED UPON REQUEST.

DESCRIPTION:
**ACCUMULATING POWER
TABLE, 48", 4" RIM, 115V**

DRAWING NUMBER:
AT-481R4XA

REVISION:
0

SIZE: D SCALE: NONE SHEET: 5 OF: 5